

# Differential pressure transmitter

## Model: SMT2001

Spec. sheet no. SD02-01

### Service intended

The high performance pressure transmitter SMT2001 is suitable to measure liquid, gas, or steam flow as well as liquid level, density and pressure.

The key features include quick response, remote set-up using communications, self-diagnostics and optional status output for pressure high/low alarm.



### Degree of protection

EN60529/IEC529/IP66

EN60529/IEC529/IP67

### Standard features

#### Accuracy

±0.05 % of calibrated span.

±0.075 % of calibrated span.

#### Range limits

1 kPa ~ 3 MPa

#### Turn down

Adjustable up to 100:1 range ability

#### Temperature compensation

High sensitivity temperature sensor packaged in the sensor

#### Measured value number

Max. 7-digit character string comprising letters and numbers.

#### Isolating diaphragm

Stainless steel 316L

Hastelloy C

Stainless steel 316L with gold plated

Stainless steel 316L with Teflon plated

#### Measurement medium

Gas, steam and liquid

#### Stability

10 years stability

0.15 % of URL

#### Output

4 ~ 20 mA with HART protocol

**WISE**<sup>®</sup>

## Principle of operation

The differential pressure transmitter includes two functional units: Main unit / auxiliary unit

The main unit includes a sensor and process connection.

The completely welded sensor module is a twin-chamber system with an integral overload diaphragm, an absolute pressure sensor, a temperature sensor and the silicon differential pressure sensor.

The absolute pressure sensor, which is only exposed to the pressure at the high pressure side, acts as a reference value to compensate for the static pressure.

The temperature sensor as a temperature compensated reference value to compensate for the temperature drift.

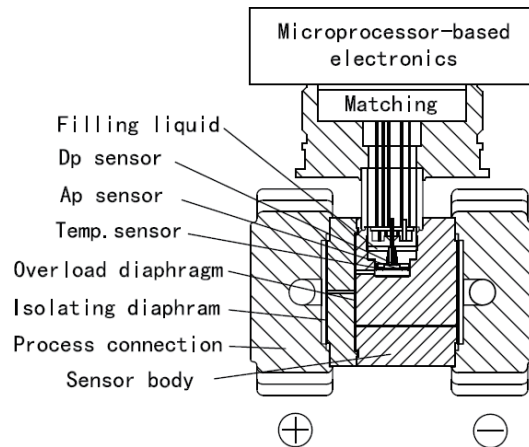

## Main specification

- The differential pressure transmitter utilize the world's leading high stability silicon sensor, the highest Reference Accuracy is  $\pm 0.05\%$
- Micro-differential pressure transmitter utilize the world's leading dual overload diaphragm patented technology, the highest Reference Accuracy is  $\pm 0.05\%$
- The absolute pressure sensor packaged in the differential pressure transmitter, can be used for static pressure measurement, display and the static pressure compensation. The minimum of the static error is  $\leq \pm 0.05\% / 10\text{ MPa}$
- High sensitivity temperature sensor packaged in the sensor. The minimum of the temperature error is  $\leq \pm 0.04\% / 10\text{ K}$
- Stainless steel 316L and silicone oil filling welded seal structure
- Long stability is  $\leq \pm 0.1\% / 3\text{ years}$ , 10 years of maintenance-free
- Adjustable up to 100:1 range ability
- The remote seal transmitter utilize ultra-high temperature ( $400\text{ }^\circ\text{C}$ ) patented technology.

## Standard Specifications

### Performance Specifications

Reference Accuracy of Calibrated Span (Includes terminal-based linearity, hysteresis, and repeatability)  
 $\pm 0.075\%$ . If  $TD > 10$ ,  $\pm(0.075 \times TD)\%$   $TD = \text{Nominal Pressure Range} / \text{Adjusted}$   
 The square root accuracy is 1.5 times of reference accuracy of calibrated span.

### Ambient Temperature Effects

$-20 \sim 65\text{ }^\circ\text{C} : \pm(0.2 \times TD + 0.05)\% \times \text{Span}$   
 Every  $10\text{ }^\circ\text{C}$  is  $\pm 0.08\% \times \text{Span}$  ( $TD=1$ )  
 $-40 \sim -20\text{ }^\circ\text{C}$  and  $65 \sim 85\text{ }^\circ\text{C} : \pm(0.3 \times TD + 0.1)\% \times \text{Span}$

### Static Pressure Effects

$\pm(0.05\% \text{URL} + 0.075\% \text{Span}) / 10\text{ MPa}$

### Overpressure Effects

$\pm 0.1\% \times \text{Span} / 10\text{ MPa}$

### Stability

$\pm 0.1\% \times \text{Span} / 3\text{ years}$

### Power Supply Effects

$\pm 0.001\% / 10\text{ V}$  ( $12 \sim 42\text{ V DC}$ )

### Explosion protection

■ ATEX, IECEx Flameproof enclosures  
 Ex db IIC T4 / T5 / T6 Gb  
 Ex tb IIIC T80°C / T90°C / T130°C Db  
 Ta =  $-40\text{ }^\circ\text{C}$  to  $+60\text{ }^\circ\text{C}$   
 ATEX Cert. : CML 17ATEX1235X  
 IECEx Cert. : IECEx CML 17.0157X

■ KCs Flameproof enclosures  
 Ex d IIC T6  
 Ta =  $-40\text{ }^\circ\text{C}$  to  $+60\text{ }^\circ\text{C}$   
 KCs Cert. : 19-KA2BO-0013X

■ KCs, ATEX, IECEx Intrinsic safety  
 Ex ia IIC T4...T6 Ga  
 Ex ia IIC T4...T6 Ga Ex ia IIIC T80°C / T90°C / T130°C Da  
 ATEX Cert. : CML 19ATEX2502X  
 IECEx Cert. : IECEx CML 19.0190X

■ KCs Intrinsic safety  
 Ex ia IIC T4/T5/T6  
 Ex iaD 20 T80°C / T90°C / T130°C  
 KCs Cert. : 20-AV2BO-0595X / 20-AV2BO-0596X

■ FM Approvals  
 CL 1, DIV 1, GPS ABCD T6...T4;  
 CL II, III, DIV 1, GPS EFG T6...T4  
 CL1, ZN 1, AEx/Ex db IIC T6...T4 Gb  
 ZN 21 AEx/Ex tb IIIC T85°C...135°C Db  
 Ta =  $-40\text{ }^\circ\text{C}$  to  $+60\text{ }^\circ\text{C}$  with Silicone o-ring  
 Ta =  $-20\text{ }^\circ\text{C}$  to  $+60\text{ }^\circ\text{C}$  with NBR o-ring  
 IP66/67  
 TYPE 4X (Only when using stainless steel housing)  
 FM Cert. : FM23US0038X / FM23CA0028X

## Functional Specifications

### Span and Range Limits

Sensor	A	B	C	D	E
Pressure range (bar)	10 mbar	60 mbar	400 mbar	2.5 bar	30 bar
Setting limits (offset and span in this range freely adjustable)	-10 ... 10 mbar	-60 ... 60 mbar	-400 ... 400 mbar	-2.5 ... 2.5 bar	-30 ... 30 bar
Lowest permissible span	1 mbar	6 mbar	4 mbar	25 mbar	0.3 bar
Permissible static pressure (Option)	70 bar	160 bar	160 bar		
			250 bar		
Range ability turndown (with respect to the differential pressure range)	10:1	10:1	100:1		

## Standard Specifications

### Turn-Down Accuracy

If the Accuracy is (%) : 0.075

If Turn-down  $\leq$  10:1,  $\pm 0.075$  % FSO

If Turn-down  $>$  10:1,  $\pm [0.0075 \times \text{Turn-down}]$  % FSO

With Turn-down = Nominal Pressure Range / Adjusted Range (FSO = Full Scale Output)

(Only available with sensor C~E.)

If the Accuracy is (%) : 0.1

If Turn-down  $\leq$  5:1,  $\pm 0.1$  % FSO

If Turn-down  $>$  5:1,  $\pm [0.01 \times \text{Turn-down} \times 2]$  % FSO

Turn-down = Nominal Pressure Range / Adjusted Range (FSO = Full Scale Output)

(Only available with sensor A.)

If the Accuracy is (%) : 0.075

If Turn-down  $\leq$  5:1,  $\pm 0.075$  % FSO

If Turn-down  $>$  5:1,  $\pm [0.0075 \times \text{Turn-down} \times 2]$  % FSO

Turn-down = Nominal Pressure Range / Adjusted Range (FSO = Full Scale Output)

(Only available with sensor B.)

### Zero Adjustment Limits

Zero can be fully elevated or suppressed, within the lower and upper range limits of the capsule.

### External Zero Adjustment

External zero is continuously adjustable with 0.01 % incremental resolution of span. Re-range can be done locally using the range setting switch.

### Mounting Position Effects

Rotation in diaphragm plane has no effect. Tilting up to 90° will cause zero shift up to 0.4 kPa which can be corrected by the zero adjustment.

### Output

2 wire 4~20 mA DC output with digital communications, linear or square root programmable.

HART FSK protocol are superimposed on the 4~20 mA DC signal.

Output range: 3.9 mA to 20.5 mA.

### Failure Alarm (The mode can be selected)

Low Alarm Mode (Min): 3.6 mA

High Alarm Mode (Max): 21 mA

Alarm Off (Keep): Keep the effective value before the fault.

\* Error signal (NAMUR NE43) : High/Low (Adjustable)

\* Note: The standard setting of failure alarm is High Mode.

### Response Time

The amplifier damping constant is 0.1 sec.

The sensor damping constant is 0.1~1.6 sec, it depends on the range and range compression ratio.

Amplifier damping time constant is adjustable from 0.1 to 60 sec by software and added to response time.

### Warm Up Time

< 15s

### Permissible Temperatures

Environment / storage without display : -40 to 85 °C

with display : -20 to 65 °C

Media wetted parts / Filled oil : -40 to 100 °C

(Info: +125°C short time, max. 30 min.)

### Working Pressure Limits (Silicone oil)

Maximum working pressure : 16 MPa (Option : 25 MPa)

### One-way limited pressure

The maximum one-way limited pressure is maximum working pressure.

## Standard Specifications

### HART digital communication and 4 to 20 mA output Power Supply

The transmitter operates from 12 to 42 V DC with no load and is protected against reverse polarity connection  
Minimum operating voltage increase to 12 V DC with surge protector

### Ripple

20 mV max on a 250  $\Omega$  load as per HART specifications.

### Load limitations

4 to 20 mA and HART total loop resistance :

$$R (\Omega) = \frac{\text{Supply voltage} - \text{min. operating voltage (V DC)}}{22 \text{ mA}}$$

A minimum of 250  $\Omega$  is required for HART communication.

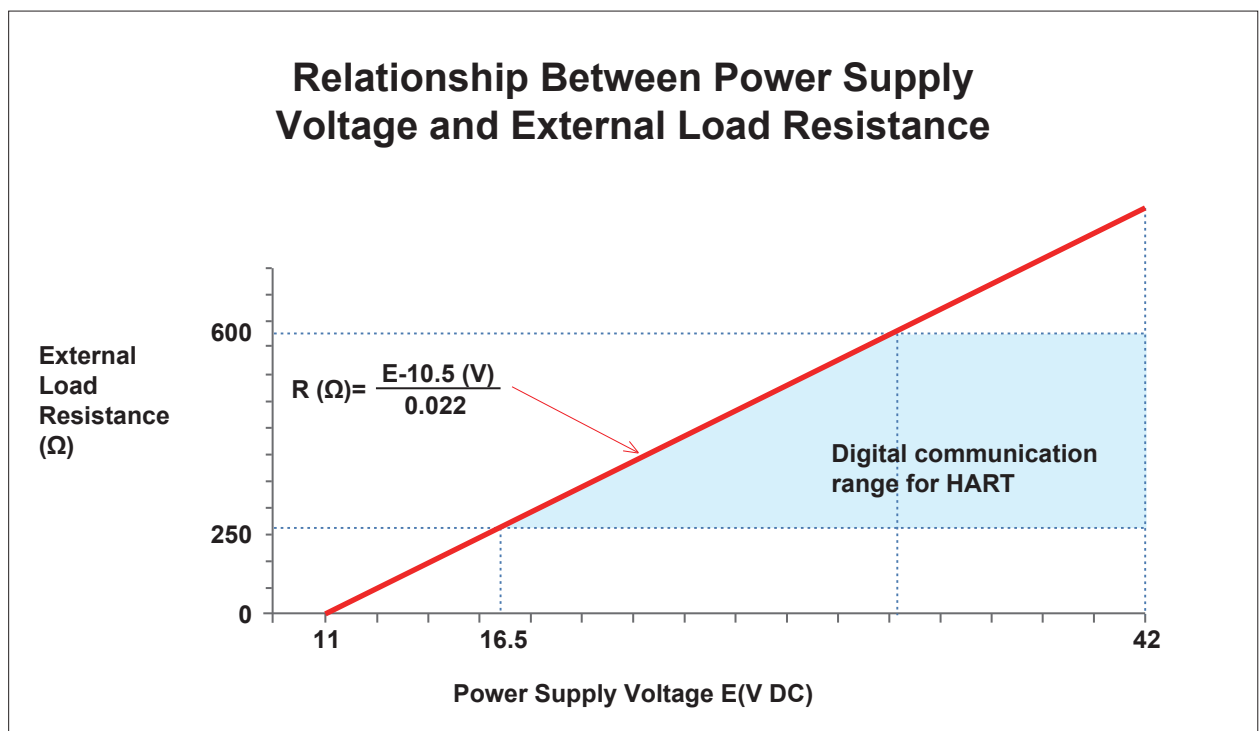

### Supply and Load Requirements

24 VDC supply,  $R \leq (U_s - 12 \text{ V}) / I_{\text{max}}$  k $\Omega$ ,  $I_{\text{max}} = 23 \text{ mA}$ .

Maximum voltage limited: 42 VDC

Minimum Voltage limited: 11 VDC without LCD display

Minimum Voltage limited: 12 VDC with LCD display

250  $\Omega$  to 600  $\Omega$  for digital communication

### Electrical Protection

Short –circuit protection is permanent.

Reverse polarity protection is not damage, but also is no function.

### Electrical Connection

The electrical connection is made via cable entry  $\frac{1}{2}$  NPT(F)

The screw terminals are suitable for wire cross-sections up to 2.5 mm<sup>2</sup>.

## Standard Specifications

### Process Connection

Flange with fixing thread 7/16-20 UNF and 1/4-18 NPT female thread on both sides.

### Electromagnetic field

Meets all the requirements of EN 61326 and NAMUR NE-21.

### Load

Within load/voltage specified limits the total effect is negligible.

## Install

The transmitter housing can be rotated about 360 degrees relative to the transmitter module without affecting the performance and internal wiring.

Transmitter can be operated Through the PC machine or notebook computer via HART modem.

HART modem can be connected in parallel to the signal circuit at arbitrary point.

The HART modem communicates with the transmitter through an AC signal superimposed on the 4~20 mA output signals. This modulation does not change in the mean values, so does not affect the measurement signal.

## Physical Specifications

### Sensor Body

Stainless steel 316SS

### Process Connector Gasket

Viton (FKM)  
Teflon (PTFE)

### Isolating Diaphragm

Stainless steel 316L  
Hastelloy C  
Gold plated on 316L  
Teflon Plated on 316L

### Amplifier Housing

Aluminium with epoxy resin coat  
Stainless steel 316

### Nuts and Bolts

stainless steel 304 / 1.4301  
Carbon steel galvanized (Static pressure 400 bar)

### Mounting Bracket

Stainless steel 304 / 1.4301  
Carbon steel galvanized

### Process Connection

Female thread 1/4"-18 NPT / fixing 7/16 UNF  
Oval flange 1/2" NPT Female thread  
Others

### Conduit Connection

1/2"NPT(F)  
M20 x 1.5P (Option)

### Name plate and tag

Stainless steel 304

### Weight

3.3 kg

### Body Flange

Stainless steel 316 / 1.4401

### Degrees of Protection

IP66/IP67

### Fill fluid

Silicone oil / Fluorinated oil

### CE conformity EMC directive

EN 61000-6-2:2005  
EN 61000-6-4:2007/A1:2011



## SMT2001 : Type of Mounting

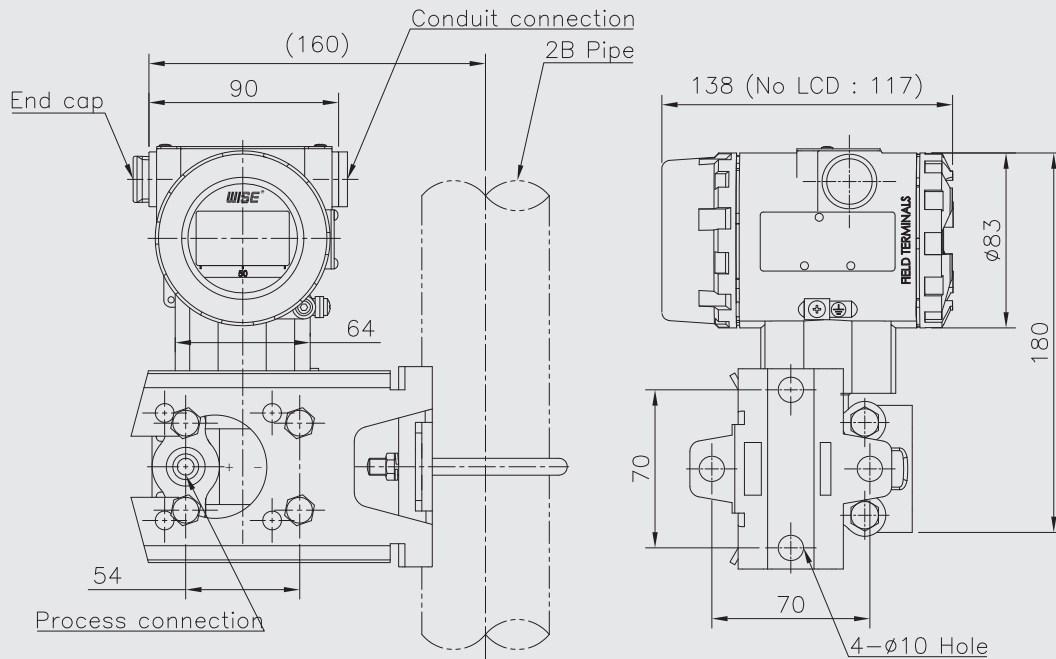

2" MOUNTING TYPE

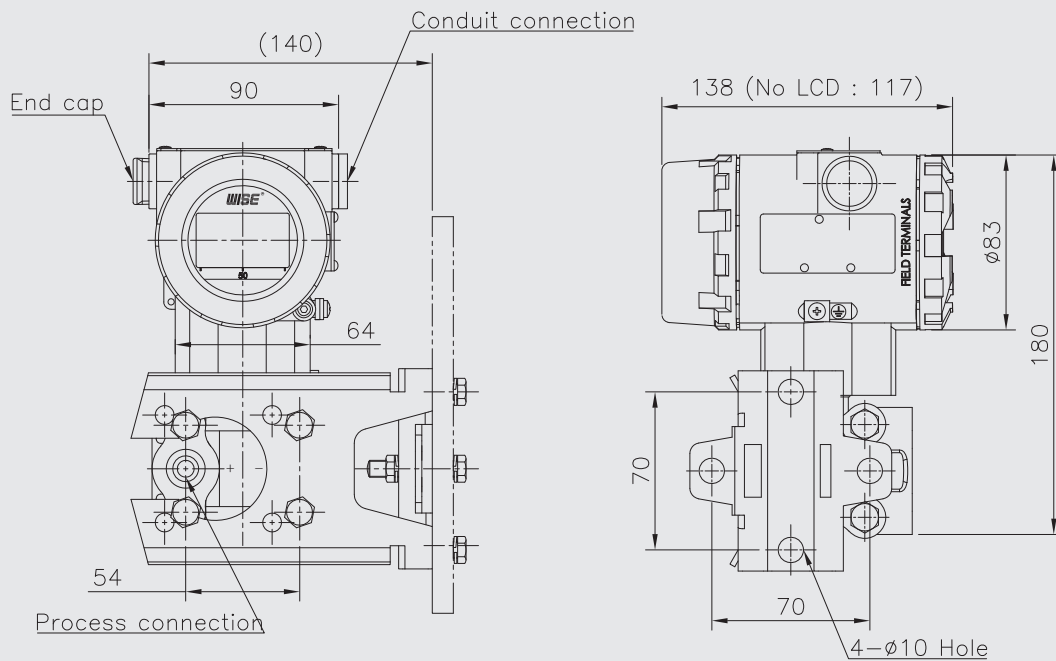

WALL MOUNTING TYPE

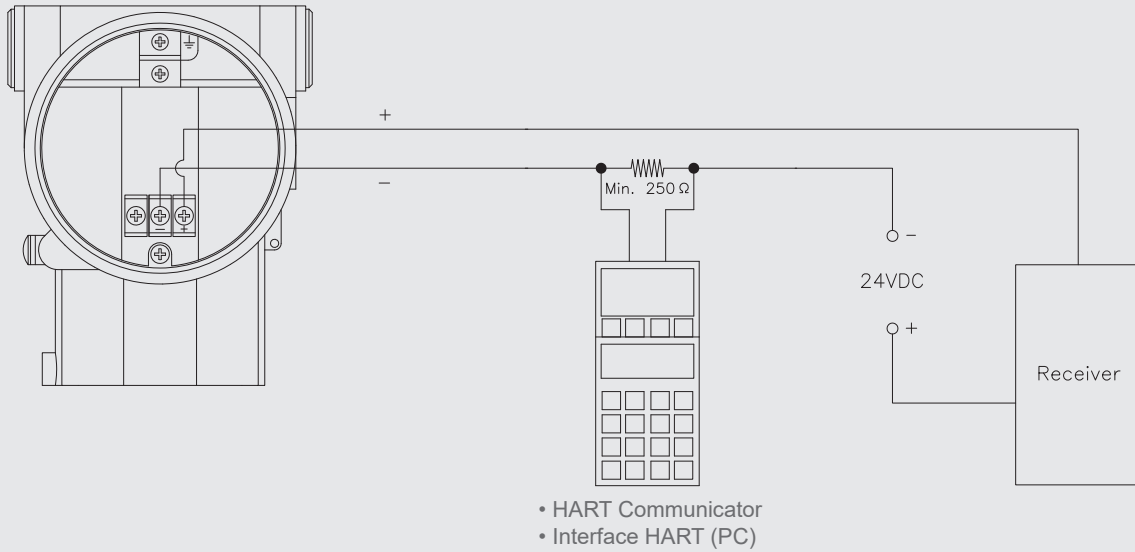

**Electrical Connection Diagram**

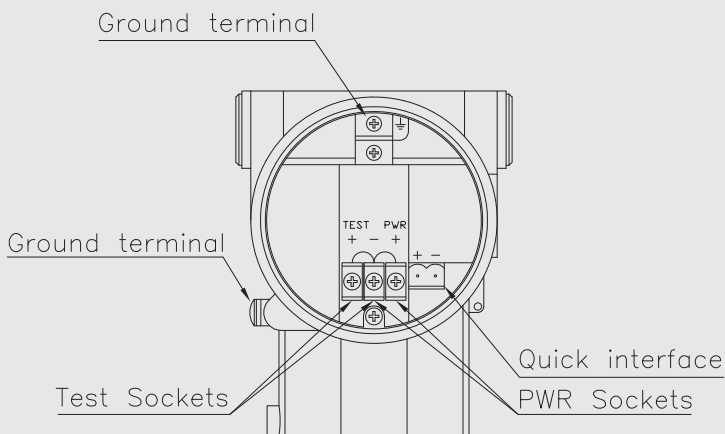

**Terminal Configuration**

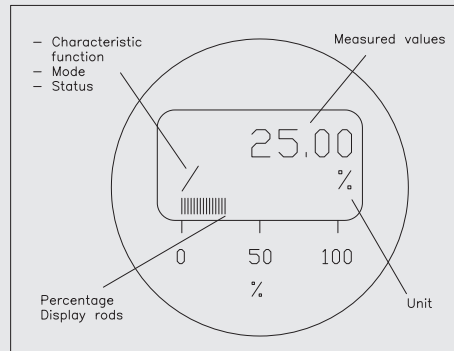

**LCD Display**

Oval-shaped flange with 1/4-18 NPT female thread (Option)

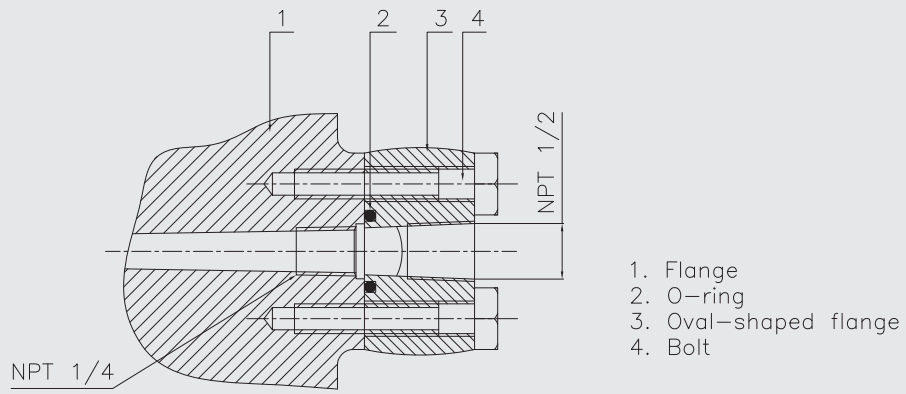

Process Connection Description

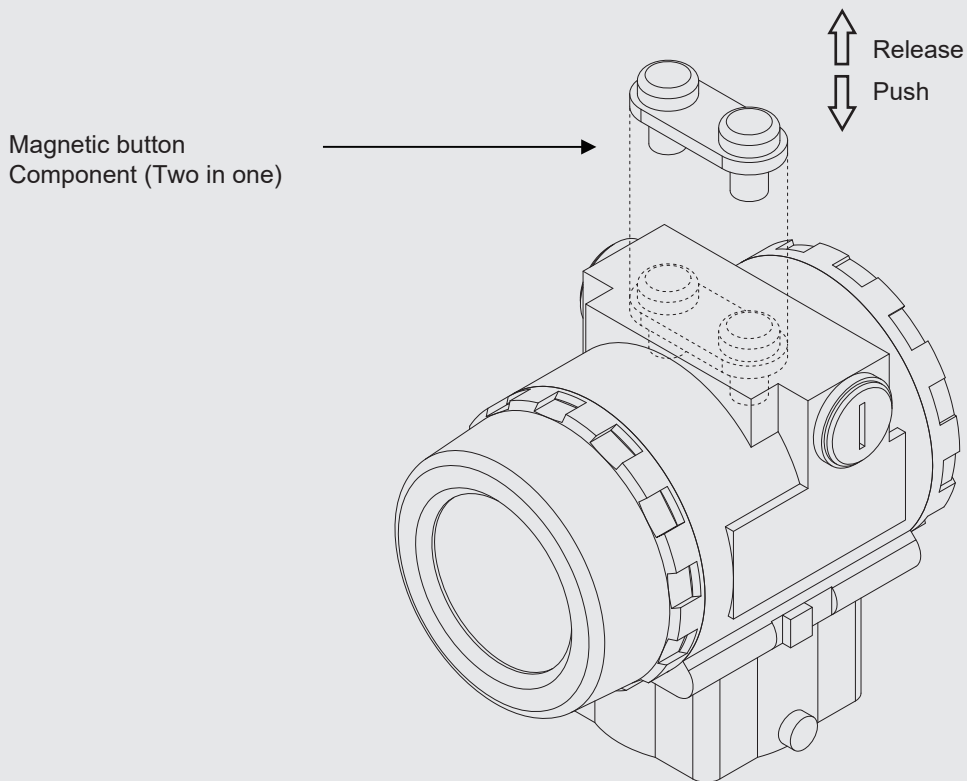

Local Set Button

**1. Base model****SMT2001** Differential Pressure Transmitter**2. Measuring Span**

- A** 1 ~ 10 mbar (Only available accuracy 0.1 %)
- B** 6 ~ 60 mbar (Only available accuracy 0.075 %)
- C** 4 ~ 400 mbar
- D** 25 ~ 2,500 mbar
- E** 0.3 ~ 30 bar

**3. Accuracy**

- 5** 0.05 % (Only C~E Sensor)
- 7** 0.075 % (Only B~E Sensor)
- 1** 0.1 % (Only A Sensor)

**4. Wetted parted materials (Seal diaphragm/Sensor Body)**

- L** 316L SS / 316SS
- H** Hastelloy C-276 / 316SS
- T** 316L SS with Teflon Plated / 316SS
- G** 316L SS with Gold Plated / 316SS

**5. Indication**

- N** None
- D** Display (LCD)

**6. Filled by fluid**

- S** Silicone oil
- F** Fluorinated oil

**7. Explosion protection**

- N** None
- A** Ex ia (ATEX)
- B** Ex ia (IECEX)
- C** Ex ia (KCS)
- D** Ex d (ATEX)
- E** Ex d (IECEX)
- F** Ex d (KCS)
- G** Ex d & tb (FM)

**8. Housing material**

- A** Aluminium 1/2" NPT(F) (STD)
- B** Aluminium M20\*1.5P(F)
- S** 316SS 1/2" NPT(F)
- T** 316SS M20\*1.5P(F)

**Sample ordering code**

1	2	3	4	5	6	7	8	9	10	11
SMT2001	A	5	L	N	S	N	A	5	Q	N
12	13	14								
7	V	1								

**9. Mounting bracket material**

- 0** None
- 5** Carbon steel galvanized
- 4** 304SS
- 8** Other

**10. Process connection**

- Q** Female thread 1/4"-18 NPT (S.T.D)
- F** Female thread 1/2" NPT  
(Oval Flange and/or manifold valve)

**11\*. Accessory**

- N** None
- 1** Oval flange
- 3** 3 way manifold valve (PTFE gasket)
- 5** 5 way manifold valve (PTFE gasket)
- 7** Oval flange with 3 way manifold valve (PTFE gasket)
- 8** Oval flange with 5 way manifold valve (PTFE gasket)
- O** Other

\* Note : Refer to A080's Specification and order valve (Manifold valve).

It requires an additional order and is a separate option.

**12. Static pressure**

- 7** 70 bar (Only measuring span A)
- 6** 160 bar
- 2** 250 bar
- 4** Other

**13. Flange gasket**

- V** Viton
- T** Teflon

**14. End plug**

- 1** Plug\_Ni Plated Brass (Only Ex proof)
- 2** Plug\_Stainless Steel (316SS) (Only Ex proof)
- 3** Plug (Without explosion protection)

## Optional specification

This catalog provides additional optional information beyond the main ordering information for the basic models of SMT200X

### 1. Select option code for marine approvals

If marine approvals is required, please select the code below.

Type	Description	Code
<b>Classification (Marine approvals)</b>	KR (Korean Register of Shipping)	KR
	ABS (American Bureau of Shipping)	AB
	DNV (Det Norske Veritas)	DN
	LR (Lloyd's Register)	LR
	BV (Bureau Veritas)	BV

### [ Example ]

SMT2001 X X X X X X X X X X X X X X \_ KR

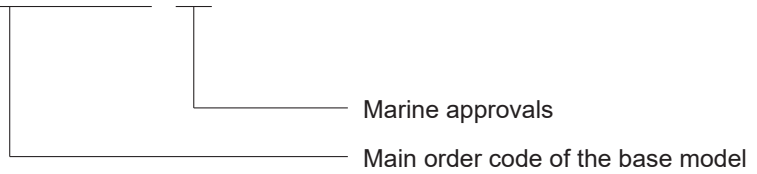

Large empty rectangular area for writing or drawing.