

# Temperature probe

for combined cold/heat meters

Basic types 902428/50 and 902428/51

Basic types 902438/50 and 902438/51

Basic types 902455/50 and 902455/51

Basic types 902465/50 and 902465/51



Operating Manual

90245550T90Z001K000

V2.00/EN/00736297/2025-02-20





# Table of contents

---

|          |   |           |
|----------|---|-----------|
| <b>1</b> | <b>Safety information</b> .....   | <b>4</b>  |
| <b>2</b> | <b>General information</b> .....  | <b>5</b>  |
| 2.1      | Object of these instructions and purpose of application .....                   | 5         |
| 2.2      | Identification marking .....  | 5         |
| <b>3</b> | <b>Technical data</b> .....   | <b>6</b>  |
| <b>4</b> | <b>Installation and maintenance</b> .....                                       | <b>7</b>  |
| 4.1      | Direct mounting, type 902455/50(51), 902428/50(51) .....                        | 8         |
| 4.2      | Direct mounting with union nut M12, type 902455/50(51), 902428/50(51) .....     | 10        |
| 4.3      | Temperature probes in short immersion sleeves (902438/50) .....                 | 10        |
| 4.4      | Installation in long immersion sleeves, type 902465/50(51), 902438/50(51) ..... | 11        |
| 4.5      | Maintenance .....   | 11        |
| <b>5</b> | <b>Declaration of conformity</b> .....  | <b>12</b> |
| <b>6</b> | <b>China RoHS</b> .....   | <b>17</b> |

---

# 1 Safety information

---

## General

This manual contains information that must be observed in the interest of your own safety and to avoid material damage. This information is supported by symbols which are used in this manual as indicated.

Please read this manual before starting up the device. Store this manual in a place that is accessible to all users at all times.

If difficulties occur during startup, please do not intervene in any way that could jeopardize your warranty rights!

---

The following standards and directives apply to the use of pairs of temperature probes for measuring the inflow and outflow temperature in a heat exchanger system:

- Product standard DIN EN 1434
- Product standard DIN EN 60751
- Directive 2014/32/EU, Annex I and MI-004
- TR-K7.1, TR-K7.2, TR-K8 and TR-K9
- German Weights and Measures Act (MessEG)
- German Weights and Measures Directive (MessEV)

---

Specifications for electrical installations must be observed.

---

All installation and maintenance work must be performed by specialist staff trained for this task.

---

All notes listed in the installation instructions must be observed.

---

Identification markings and metrology-relevant safety markings/main stamps must not be damaged or removed – otherwise the temperature probes are no longer admissible for use!

---

Route the measurement signal lines so that they are at least 50 mm away from other lines, such as grid supply lines and data transmission lines. We recommend installing lines and computer units 300 mm away from strong electromagnetic fields, e.g. from frequency-controlled pumps and high-voltage power lines.

---

To protect against damage and pollutants, the temperature probes must not be removed from their packaging until immediately before installation.

---

Do not wind, bend, extend, or shorten the temperature probe lines.

---

When connecting to a computer unit, always connect the temperature probes first before connecting the volume measuring unit.

---

## Warning symbols



### **WARNING!**

#### **Risk of burns!**

The installation process must be carried out by trained personnel.

When using water additives (corrosion protection, etc.), the operator must make sure there is sufficient corrosion resistance before installing the temperature probe.

With direct mounting, the temperature probe is immersed in the pipeline without any additional immersion sleeve. During dismounting, always make sure that hot medium does not escape from the pipeline.

- ▶ Drain the pipeline system or seal off the temperature probe's installation location to relieve pressure.
-

### 2.1 Object of these instructions and purpose of application

The standard DIN EN 1434 describes the requirements for heat meters and their sub-components. When combining sub-components (flow sensor, pair of temperature probes, computer unit) to form a heat meter, the standard prescribes platinum RTD temperature probes according to the standard DIN EN 60751:2009/IEC 60751:2008 because these probes have sufficient measurement stability, accuracy, and interchangeability.

These days, the latest heat meters use various nominal values on the computer unit side (resistance value at 0 °C). The nominal values are normally 100 Ω (Pt100), 500 Ω (Pt500), and 1000 Ω (Pt1000).

The temperature probes from the type series 902425/50(51) and 902455/50(51) for direct mounting and 902438/50(51) and 902465/50(51) for installation in immersion sleeves are type-tested according to the European Measuring Instruments Directive 2014/32/EU (MID) including Annexes I and MI-004. The paired temperature probes are suitable for being connected to a computer unit for a heat meter and measure the difference between the inflow and outflow temperature in a heat exchanger system.

The temperature probes are made up of a corrosion-resistant protection fitting. The connecting cable is permanently connected to the temperature probe.

In order to meet the metrological requirements of the European Measuring Instruments Directive 2014/32/EU (MID) and the Annex MI-004, the temperature probes are calibrated at three temperatures and paired according to a special mathematical process in order to comply with the tolerance for the temperature difference. The lower limit for the temperature difference is 3 K.

### 2.2 Identification marking

Each temperature probe pair is equipped with a nameplate containing the following information:

- CE identification marking with ID codes for the notified bodies appointed to certify module D (production quality assurance)
- Metrology identification marking, including the two digits for the year in which the identification marking was created
- Logo for the owner of the type examination certificate
- Type examination certificate number
- Pair number/ID
- Manufacturing date (year/calendar week)
- Manufacturing location (in-house code)
- Type number
- Admissible measuring range (temperature, temperature difference)
- Maximum pressure stage
- Nominal value
- Manufacturer's address

The inflow and outflow probes are distinguished by colored identification markings on the temperature probe's cable (red: inflow, blue: outflow) or using an identification marking on the nameplate (V = inflow, R = outflow).

### 3 Technical data

|   |   |
|---|---|
| Temperature range<br>902455/50(51), 902428/50(51)<br>902465/50(51), 902438/50(51)   | 0 to 150 °C<br>0 to 150 °C<br>The maximum operating temperature of the immersion sleeves must be observed.  |
| Protection type   | IP65 (as delivered condition)<br>In heat applications, it must be ensured that the dew point is not reached or undershot.   |
| Temperature difference<br>Minimum<br>Maximum  | 3 K<br>150 K  |
| Maximum pressure<br>902455/50(51), 902428/50(51)<br>902465/50(51), 902438/50(51)  | PS25 for a water flow velocity of 2 m/s<br>With immersion sleeves according to 90.279-F05, sheet 3, 4, 5, and 6<br>PS25 for a water flow velocity of 2 m/s  |
| Electrical connection   | Two-wire, four-wire   |
| Maximum measuring current   | The maximum measuring current is calculated using the maximum admissible power loss of 5 mW.<br>Depending on the nominal values, this results in the following effective current values:<br>Pt100: 1783 µA<br>Pt500: 797 µA<br>Pt1000: 564 µA   |
| Response times<br>Temperature probe, direct measurement<br>902455/50, 902428/50<br>Diameter 5.0 mm<br>Diameter 6.0 mm<br>902455/51, 902428/51<br>Diameter 5.0 mm<br>Diameter 6.0 mm<br>Temperature probe, in immersion sleeve<br>902465/50, 902438/50<br>Diameter 5.0 mm<br>Diameter 6.0 mm<br>902465/51, 902438/51<br>Diameter 5.0 mm<br>Diameter 6.0 mm | $t_{0,5} \leq 3.5 \text{ s}; t_{0,9} \leq 10.5 \text{ s}$<br>$t_{0,5} \leq 5.0 \text{ s}; t_{0,9} \leq 11.5 \text{ s}$<br>$t_{0,5} \leq 2.5 \text{ s}; t_{0,9} \leq 7.6 \text{ s}$<br>$t_{0,5} \leq 4.0 \text{ s}; t_{0,9} \leq 10.1 \text{ s}$<br>$t_{0,5} \leq 7.5 \text{ s}; t_{0,9} \leq 27.0 \text{ s}$<br>$t_{0,5} \leq 11.0 \text{ s}; t_{0,9} \leq 30.0 \text{ s}$<br>$t_{0,5} \leq 7.0 \text{ s}; t_{0,9} \leq 22.9 \text{ s}$<br>$t_{0,5} \leq 10.1 \text{ s}; t_{0,9} \leq 28.7 \text{ s}$ |
| Minimum immersion depth   | 15 mm at maximum temperature up to 105 °C<br>20 mm at maximum temperature up to 150 °C  |
| Nominal value   | Pt100, Pt500, Pt1000 (see identification marking for temperature probes)  |
| Tolerance sensor  | Class F0,3 according to DIN EN 60751:2023 / IEC 60751:2022; restricted tolerances optional<br>With the complete temperature sensor in two-wire technology, the display will be systematically higher due to the additional line resistance (see maximum connection length according to DIN EN 1434).  |

## 4 Installation and maintenance

---

If the pair of temperature probes is connected to a computer unit, make sure that the probe's nominal value matches that of the processing computer unit.

Furthermore, make sure that the installation location is deep enough to prevent damage to the tip of the probe or immersion sleeve when screwing in.

The temperature probe must be installed in the pipeline so that a sufficient immersion depth is guaranteed that is greater than the minimum immersion depth in all cases.

During installation, the connection cable must not be shortened or extended as this would impair compliance with the tolerances (for two-wire technology).

Extending the connecting cable is admissible only using an extension socket for temperature probe pairs according to the mounting specifications 90244299A47Z001K000.

To prevent an inductive effect, the connecting cable must not be wound.

The connecting cable must not be laid alongside or wrapped around hot pipes because the line resistance and its temperature dependence are considered in the measurement result for thermometers using two-wire technology.

Following successful mounting, the temperature probes must be secured against manipulation with a seal. The sealing hole in the attachment screw or nameplate is intended for this purpose. The sealing set is available as part no. 00650727.

The installation point of the inflow and outflow probes must be identical (symmetrical installation), unless the non-symmetrical installation is approved by the meter manufacturer.



### **NOTE!**

The following specifications apply for Germany according to the technical directives TR-K8 and TR-K9: For heat/cold meters with nominal flow rates less than or equal to  $q_p 6 \text{ m}^3/\text{h}$ , the temperature probe must only be installed with direct immersion when installing the section of the pipeline in the measuring point area with nominal pressures lower than or equal to 16 bar. Tolerances apply for existing immersion sleeves.

---

## 4 Installation and maintenance

### 4.1 Direct mounting, type 902455/50(51), 902428/50(51)

If the temperature probes are installed directly, the installation locations must be designed according to the DIN EN 1434-2:2022 standard (see the figure below). The components must be mounted according to the mounting specifications. Make sure that the seal and sealing surface in the installation location are undamaged, clean, and dry.

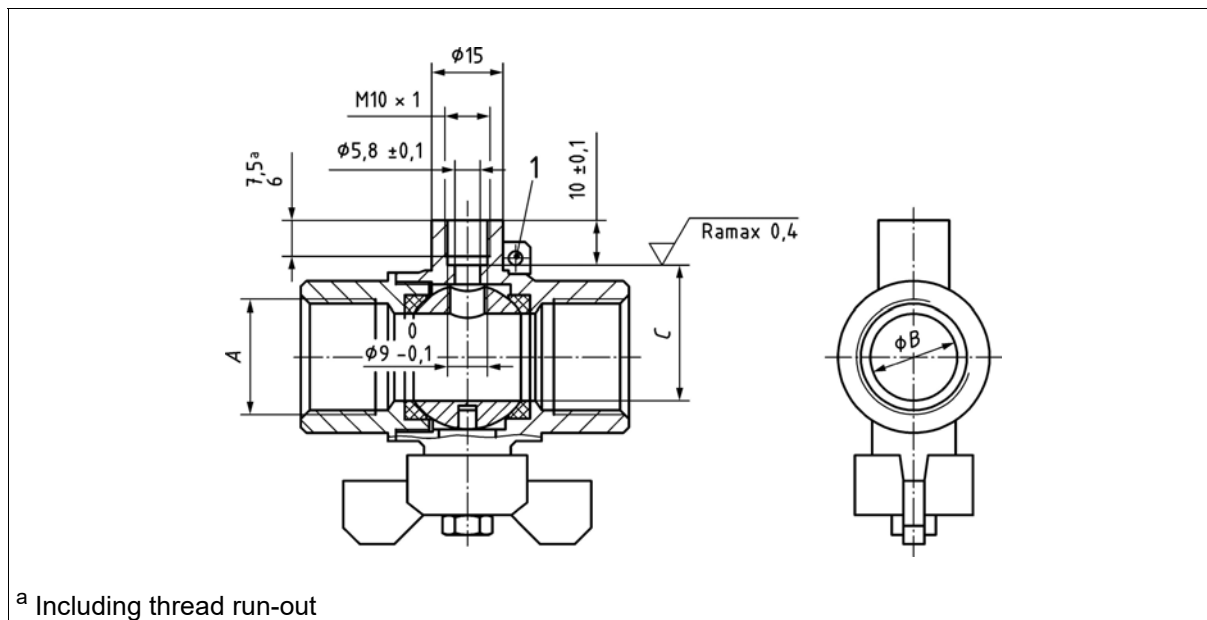

| Thread size A | Inner diameter B | Length C | Recommended temperature probe |
|---------------|------------------|----------|-------------------------------|
| G 1/2 B       | 15 mm            | 29 mm    | Direct, short, 27.5 mm        |
| G 3/4 B       | 19 mm            | 31 mm    | Direct, short, 27.5 mm        |
| G 1 B         | 25 mm            | 36 mm    | Direct, short, 27.5 mm        |
| G 1 1/4 B     | 32 mm            | 46 mm    | Direct, short, 38 mm          |
| G 1 1/2 B     | 40 mm            | 55 mm    | Direct, short, 38 mm          |
| G 2 B         | 49 mm            | 49 mm    | Direct, short, 60 mm          |



#### NOTE!

The minimum immersion depth for the temperature probes is 15 mm.



#### NOTE!

Only temperature probes with diameters of 5.0 mm or 5.2 mm are admissible for direct mounting in ball valves with an M10 internal thread.

## 4 Installation and maintenance

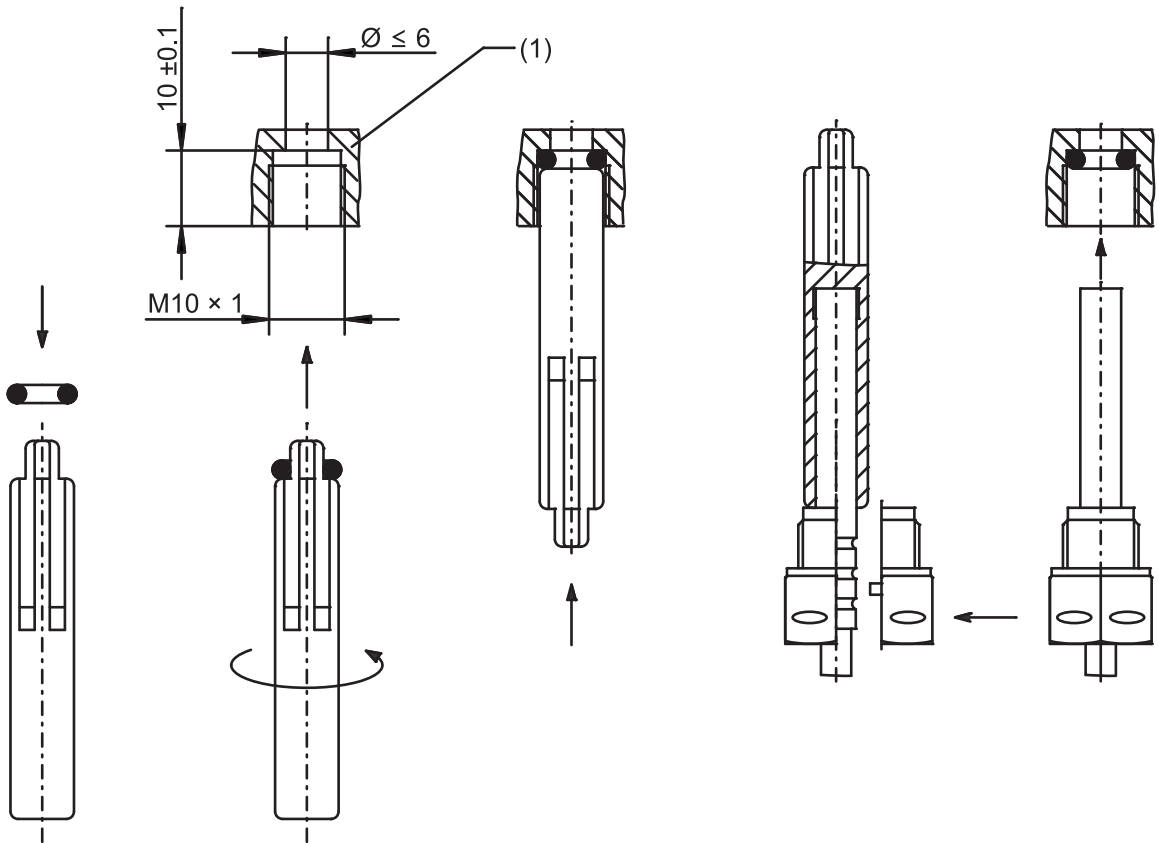

1. Remove the blind plugs and seal or the old probe and O-ring so that no residue is left behind.
2. Place the O-ring from the supplied mounting set onto the assembly aid.
3. Using the assembly aid, insert the O-ring into the installation location according to DIN EN 1434 (1) using a rotating motion.
4. Set the O-ring in its final position in the installation location using the other end of the assembly aid.
5. Pull the end of the assembly aid over the temperature probe sleeve – up to the limit stop in the assembly aid (to determine the probe installation length).  
Grasp the two halves of the black plastic quick-release screw directly above the assembly aid and press into the recesses (beads) on the temperature probe sleeve.  
Remove the assembly aid from the temperature probe.  
Press both halves of the screw connection firmly together.
6. Press the temperature probe with the black plastic quick-release screw into the installation location and screw it in to the limit stop so that it is hand-tight (tightening torque of 3 to 5 Nm).
7. Check that there is no leakage and seal the temperature probe.



### NOTE!

A new O-ring must be used after each dismounting process.

## 4 Installation and maintenance

---

### 4.2 Direct mounting with union nut M12, type 902455/50(51), 902428/50(51)

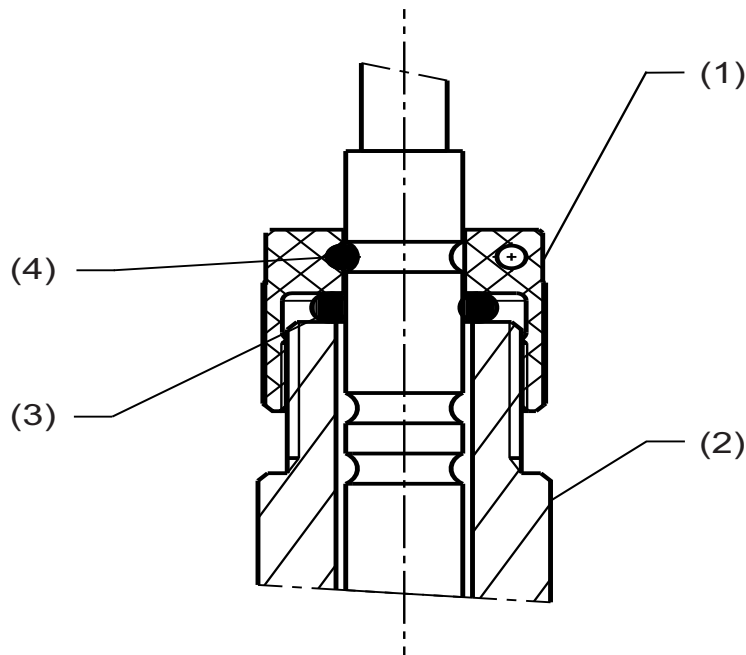

1. Using the half-length taper grooved pin (4), mount the union nut (1) into the last groove of the temperature probe sleeve.
2. Slide the O-ring (3) onto the free space between the last and middle groove.
3. Screw the temperature probe with union nut into the M12 installation location (2) (tightening torque of 6 to 10 Nm).

### 4.3 Temperature probes in short immersion sleeves (902438/50)

If the temperature probe is installed in a short immersion sleeve, the installation specification 90.279-F50-3MV must be observed. Before fixing the temperature probe in the short immersion sleeve, always check that the temperature probe is inserted all the way into the short immersion sleeve and is in contact with the base.

## 4 Installation and maintenance

### 4.4 Installation in long immersion sleeves, type 902465/50(51), 902438/50(51)

If necessary, the temperature probes can also be designed for installation in long immersion sleeves. In this version, cable clamping sleeves are located on the cable. Before mounting, check that the correct cable clamping sleeves are being used by measuring the immersion sleeve length.



#### NOTE!

The number of cable clamping sleeves on the cable may vary.

Ensure that the outer diameter of the temperature probes is admissible for the internal diameter of the immersion sleeve.

The temperature probe is fixed in the basic type 902440/43 immersion sleeve using a lateral sealing screw on the cable clamping sleeve. For the basic type 902440/45 immersion sleeve, the temperature probe is fixed using a G 1/4 plastic screw connection.

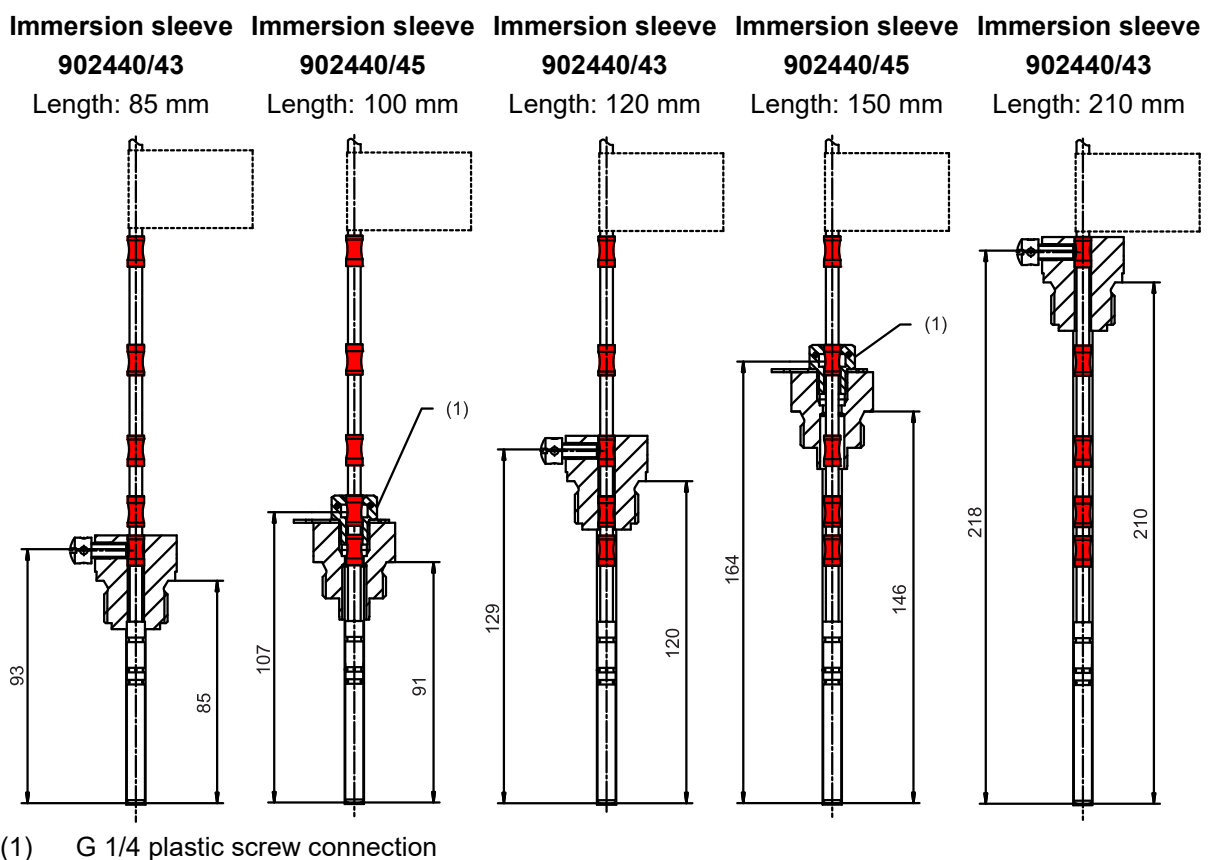

### 4.5 Maintenance

In order to maintain measurement stability, a measurement inspection must be carried out when the national calibration period has elapsed to check that the maximum permissible error (MPE) is observed.

# 5 Declaration of conformity

JUMO GmbH & Co. KG

Moritz-Juchheim-Straße 1  
36039 Fulda, Germany

Telefon: +49 661 6003-0

E-Mail: mail@jumo.net  
Internet: www.jumo.net



## Konformitätserklärung

**Dokument Nr.:** DE-017  
**Hersteller:** JUMO GmbH & Co. KG  
**Anschrift:** Moritz-Juchheim-Straße 1, 36039 Fulda, Germany  
**Produkt:**  
Beschreibung: Temperaturfühler für Kältezähler  
Typ/ Serie: 902455/20; 902455/21; 902455/50; 902455/51;  
902455/70; 902455/71; 902465/50; 902465/51  
Typenblatt-Nr.: 902455; 902465

Der Hersteller bestätigt, dass der oben beschriebene Gegenstand der Erklärung das Mess- und Eichgesetz und die darauf gestützten Rechtsverordnungen einhält.

### Angewandte Gesetze:

MessEG [Mess- und Eichgesetz] Ausgabe: 2013

### Angewendete Normen:

DIN EN 1434-1 Ausgabe: 2019  
DIN EN 1434-2 Ausgabe: 2019  
DIN EN 1434-4 Ausgabe: 2019  
DIN EN 1434-5 Ausgabe: 2019  
DIN EN 60751 Ausgabe: 2009

### Angewendete Regelwerke:

Ermittelter Regeln und Erkenntnisse des  
Regelermittlungsausschusses nach  
§ 46 des Mess- und Eichgesetzes Ausgabe: 2022

### Baumusterprüfbescheinigung (Bauartzulassung):

DE-15-M-PTB-0052 Aussteller: PTB Berlin

### Anerkannte Qualitätssicherungssysteme der Produktion:

Anlage 4 Teil B Modul D der Mess- und Eichverordnung vom 11.12.2014 (BGBl. I S. 2010), Abs. 3.2 u. 3.3  
Physikalisch Technische Bundesanstalt Braunschweig, Nr. der Stelle: 0102  
Konformitätsbewertungsstelle – QM-Systembewertungen von Messgeräteherstellern  
Zertifikatsnummer: DE-M-AQ-PTB002

**Aussteller**

**Firma**

JUMO GmbH & Co. KG, Fulda

Ort, Datum: *Fulda, 2022-11-11*

Fulda, 2022-11-11

### Rechtsverbindliche Unterschriften:

BL Globaler Vertrieb  
Markus Belmer

Qualitätsbeauftragter und Leiter Qualitätswesen  
i. V. Harald Gienger

*ppc. Markus Belmer*

*i.v. Harald Gienger*

Dokument-Nr. DE-017

Konformitätserklärung

Seite 1 von 1

# 5 Declaration of conformity

## JUMO GmbH & Co. KG

Moritz-Juchheim-Straße 1  
36039 Fulda, Germany

Tel.: +49 661 6003-0  
Fax: +49 661 6003-500

E-Mail: mail@jumo.net  
Internet: www.jumo.net



MORE THAN SENSORS  
AND AUTOMATION

## EU-Konformitätserklärung

EU declaration of conformity / Déclaration UE de conformité

**Dokument-Nr.** CE 433  
*Document No. / Document n°.*

**Hersteller** JUMO GmbH & Co. KG  
*Manufacturer / Etabli par*

**Anschrift** Moritz-Juchheim-Straße 1, 36039 Fulda, Germany  
*Address / Adresse*

### Produkt

*Product / Produit*

| <b>Name</b><br><i>Name / Nom</i>         | <b>Typ</b><br><i>Type / Type</i> | <b>Typenblatt-Nr.</b><br><i>Data sheet no. / N°<br/>Document<br/>d'identification</i> |
|--|----------------------------------|---|
| JUMO HEATtemp - RTD - Types DS<br>and PS | 902428/50                        | 902428  |
| JUMO HEATtemp - RTD - Types DS<br>and PS | 902428/51                        | 902428  |
| JUMO HEATtemp - RTD - Types DS<br>and PS | 902438/50                        | 902438  |
| JUMO HEATtemp - RTD - Types DS<br>and PS | 902438/51                        | 902438  |

**Wir erklären in alleiniger Verantwortung, dass das bezeichnete Produkt die Anforderungen der Europäischen Richtlinien erfüllt.**

*We hereby declare in sole responsibility that the designated product fulfills the requirements of the European Directives.*

*Nous déclarons sous notre seule responsabilité que le produit remplit les Directives Européennes.*

Dokument-Nr.  
Document No. / Document n°.

CE 433

EU-Konformitätserklärung

Seite: 1 von 4

# 5 Declaration of conformity

## JUMO GmbH & Co. KG

Moritz-Juchheim-Straße 1  
36039 Fulda, Germany

Tel.: +49 661 6003-0  
Fax: +49 661 6003-500

E-Mail: mail@jumo.net  
Internet: www.jumo.net



**MORE THAN SENSORS  
AND AUTOMATION**

### 1. Richtlinie

*Directive / Directive*

#### Name

MID 2014/32/EU

*Name / Nom*

#### Konformitätsbewertungsverfahren

Mod. B+D

*Conformity assessment procedure /*

*Procédure d'évaluation de la conformité*

#### Datum der Erstanbringung des CE-Zeichens auf dem Produkt

2007

*Date of first application of the CE mark to the product /*

*Date de 1ère application du sigle sur le produit*

#### Gültig für Typ

*Valid for Type / Valable pour le type*

902428/50-...

902428/51-...

902438/50-...

902438/51-...

#### 1.1 EU-Baumusterprüfbescheinigung

*EU type examination certificate / Certificat d'examen de type UE*

#### Zertifikatsnummer

A 0445/2112/2007

*Certificate number / Numéro de certificat*

#### Notifizierte Stelle

Bundesamt für Eich- und Vermessungswesen

*Notified Body / Organisme notifié*

(BEV), Airtgasse 35, 1160 Wien, Austria

# 5 Declaration of conformity

## JUMO GmbH & Co. KG

Moritz-Juchheim-Straße 1  
36039 Fulda, Germany

Tel.: +49 661 6003-0  
Fax: +49 661 6003-500

E-Mail: mail@jumo.net  
Internet: www.jumo.net



**MORE THAN SENSORS  
AND AUTOMATION**

### Angewendete Normen/Spezifikationen

*Standards/Specifications applied / Normes/Spécifications appliquées*

| <b>Referenz</b><br><i>Reference / Référence</i> | <b>Ausgabe</b><br><i>Edition / Édition</i> | <b>Bemerkung</b><br><i>Comment / Remarque</i>         |
|---|--|---|
| EN 1434-1                                       | 2015+A1:2018                               | The edition 2007 is met for presumption of conformity |
| EN 1434-2                                       | 2015+A1:2018                               | The edition 2007 is met for presumption of conformity |
| EN 1434-4                                       | 2015+A1:2018                               | The edition 2007 is met for presumption of conformity |
| EN 1434-5                                       | 2015+A1:2019                               | The edition 2007 is met for presumption of conformity |
| EN 60751  | 2008                                       |   |
| OIML R75-2                                      | 2002                                       |   |

### Qualitätssicherung bezogen auf den Produktionsprozess

*Quality assurance of the production process / L'assurance de la qualité de la production*

**Zertifikatsnummer** Available on request.  
*Certificate number / Numéro de certificat*

**Notifizierte Stelle** Physikalisch-Technische-Bundesanstalt (PTB),  
*Notified Body / Organisme notifié* Bundesallee 100, 38116 Braunschweig,  
Germany

**Kennnummer** 0102  
*Identification no. / N° d'identification*

### Allgemeine Bemerkungen

*General remarks / Observations générales*

Annex II Module D of Directive 2014/32/EU of the European Parliament and of the Council of 26 February 2014 on measuring instruments (ABI. EG Nr. L 180)

Physikalisch-Technische Bundesanstalt Braunschweig, Body No.: 0102

Conformity assessment body, Assessment of QM-Systems of manufacturers of measuring instruments

Certificate No.: DE-M-AQ-PTB002

Dokument-Nr.  
Document No. / Document n°.

CE 433

EU-Konformitätserklärung

Seite: 3 von 4

# 5 Declaration of conformity

## JUMO GmbH & Co. KG

Moritz-Juchheim-Straße 1  
36039 Fulda, Germany

Tel.: +49 661 6003-0  
Fax: +49 661 6003-500

E-Mail: mail@jumo.net  
Internet: www.jumo.net



**MORE THAN SENSORS  
AND AUTOMATION**

### Aussteller

*Issued by / Etabli par*

JUMO GmbH & Co. KG

### Ort, Datum

*Place, date / Lieu, date*

Fulda, 2024-12-06

### Rechtsverbindliche Unterschriften

*Legally binding signatures /*

*Signatures juridiquement valable*

Bereichsleitung Globaler Vertrieb

i. V. Sevil Davarci

Leiter Managementsysteme

i. V. Matthias Raab

Dokument-Nr.  
Document No. / Document n°.

CE 433

EU-Konformitätserklärung

Seite: 4 von 4

|   |  |   |           |           |                 |               |                 |
|--|--|---|-----------|-----------|-----------------|---------------|-----------------|
| 产品组别<br>Product group: 902455  |  | 产品中有害物质的名称及含量<br>China EEP Hazardous Substances Information |           |           |                 |               |                 |
| 部件名称<br>Component Name   |  | 铅<br>(Pb)   | 汞<br>(Hg) | 镉<br>(Cd) | 六价铬<br>(Cr(VI)) | 多溴联苯<br>(PBB) | 多溴二苯醚<br>(PBDE) |
| 外壳<br>Housing<br>(Gehäuse)   |  | ○   | ○         | ○         | ○               | ○             | ○               |
| 过程连接<br>Process connection<br>(Prozessanschluss)   |  | X   | ○         | ○         | ○               | ○             | ○               |
| 螺母<br>Nuts<br>(Mutter)   |  | ○   | ○         | ○         | ○               | ○             | ○               |
| 螺栓<br>Screw<br>(Schraube)  |  | ○   | ○         | ○         | ○               | ○             | ○               |
| <p>本表格依据SJ/T 11364的规定编制。<br/>This table is prepared in accordance with the provisions SJ/T 11364.<br/>○：表示该有害物质在该部件所有均质材料中的含量均在GB/T 26572规定的限量要求以下。<br/>Indicate the hazardous substances in all homogeneous materials' for the part is below the limit of the GB/T 26572.</p> <p>×：表示该有害物质至少在该部件的某一均质材料中的含量超出GB/T 26572规定的限量要求。<br/>Indicate the hazardous substances in at least one homogeneous materials' of the part is exceeded the limit of the GB/T 26572.</p> |  |   |           |           |                 |               |                 |

|   |  |   |           |           |                 |               |                 |
|--|--|---|-----------|-----------|-----------------|---------------|-----------------|
| 产品组别<br>Product group: 902465  |  | 产品中有害物质的名称及含量<br>China EEP Hazardous Substances Information |           |           |                 |               |                 |
| 部件名称<br>Component Name   |  | 铅<br>(Pb)   | 汞<br>(Hg) | 镉<br>(Cd) | 六价铬<br>(Cr(VI)) | 多溴联苯<br>(PBB) | 多溴二苯醚<br>(PBDE) |
| 外壳<br>Housing<br>(Gehäuse)   |  | ○   | ○         | ○         | ○               | ○             | ○               |
| 过程连接<br>Process connection<br>(Prozessanschluss)   |  | ○   | ○         | ○         | ○               | ○             | ○               |
| 螺母<br>Nuts<br>(Mutter)   |  | ○   | ○         | ○         | ○               | ○             | ○               |
| 螺栓<br>Screw<br>(Schraube)  |  | ○   | ○         | ○         | ○               | ○             | ○               |
| <p>本表格依据SJ/T 11364的规定编制。<br/>This table is prepared in accordance with the provisions SJ/T 11364.<br/>○：表示该有害物质在该部件所有均质材料中的含量均在GB/T 26572规定的限量要求以下。<br/>Indicate the hazardous substances in all homogeneous materials' for the part is below the limit of the GB/T 26572.</p> <p>×：表示该有害物质至少在该部件的某一均质材料中的含量超出GB/T 26572规定的限量要求。<br/>Indicate the hazardous substances in at least one homogeneous materials' of the part is exceeded the limit of the GB/T 26572.</p> |  |   |           |           |                 |               |                 |

## 6 China RoHS

---





**JUMO GmbH & Co. KG**

Street address:  
Moritz-Juchheim-Straße 1  
36039 Fulda, Germany

Delivery address:  
Mackenrodtstraße 14  
36039 Fulda, Germany

Postal address:  
36035 Fulda, Germany

Phone: +49 661 6003-0  
Fax: +49 661 6003-607  
Email: [mail@jumo.net](mailto:mail@jumo.net)  
Internet: [www.jumo.net](http://www.jumo.net)

**JUMO UK LTD**

JUMO House  
Temple Bank, Riverway  
Harlow, Essex, CM20 2DY, UK

Phone: +44 1279 63 55 33  
Fax: +44 1279 62 50 29  
Email: [sales@jumo.co.uk](mailto:sales@jumo.co.uk)  
Internet: [www.jumo.co.uk](http://www.jumo.co.uk)

**JUMO Process Control, Inc.**

6724 Joy Road  
East Syracuse, NY 13057, USA

Phone: +1 315 437 5866  
Fax: +1 315 437 5860  
Email: [info.us@jumo.net](mailto:info.us@jumo.net)  
Internet: [www.jumousa.com](http://www.jumousa.com)

