

# **Screw connection for temperature probe installation in plastic or brass**

Installation Instructions



90244261T94Z001K000

V2.00/EN/00669425



<b>1</b>	<b>Safety information</b> .....	<b>4</b>
<b>2</b>	<b>Installation specifications for direct mounting</b> .....	<b>5</b>
2.1	Plastic screw connection.....	5
2.2	Brass screw connection.....	6
<b>3</b>	<b>Installation specifications for immersion sleeve</b> .....	<b>8</b>

# 1 Safety information

---

## General information

This manual contains information that must be observed in the interest of your own safety and to avoid material damage. This information is supported by symbols which are used in this manual as indicated.

Please read this manual before starting up the device. Store this manual in a place that is accessible to all users at all times.

If difficulties occur during startup, please do not intervene in any way that could jeopardize your warranty rights!

## Warning symbols



### CAUTION!

#### Risk of burns!

The installation process must be carried out by trained personnel.

With direct mounting, the temperature probe is immersed in the pipeline without any additional immersion sleeve. During dismounting, always make sure that hot medium does not escape from the pipeline.

- ▶ Drain the pipeline system or seal off the temperature probe's installation location to relieve pressure.
-

## 2 Installation specifications for direct mounting

### 2.1 Plastic screw connection

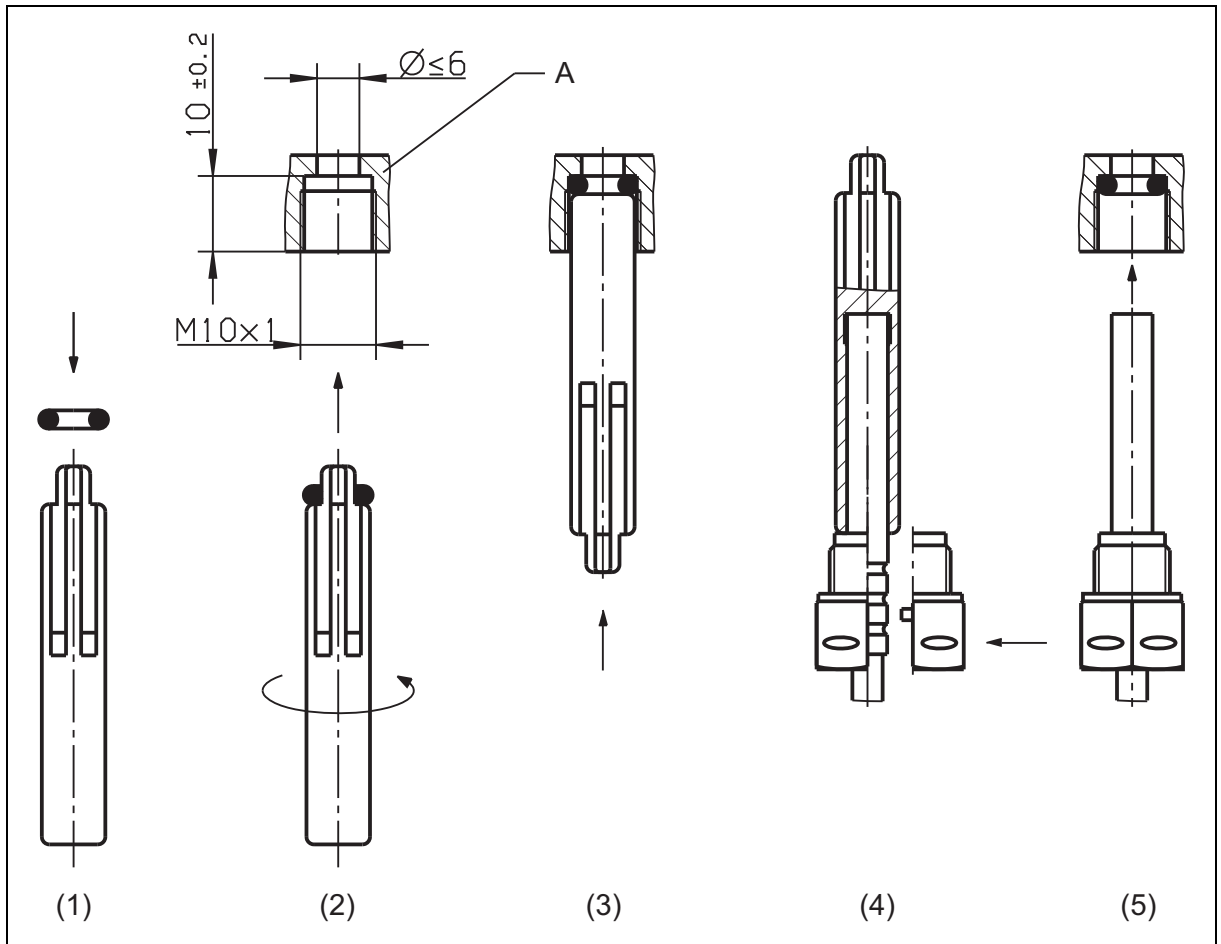

1. Place the O-ring from the supplied set onto the assembly aid.
2. Place the O-ring with the assembly aid into the installation location using a rotating motion according to DIN EN 1434.
3. Place the O-ring into the final installation location using the other end of the assembly aid.
4. Pull the assembly aid with the end over the temperature probe sleeve – up to the limit stop in the assembly aid (to determine the probe installation length).

Grasp the two halves of the plastic screw directly above the assembly aid and press into the **3 recesses** (beads) on the temperature probe sleeve. Press both halves of the screw connection firmly together.

Remove the assembly aid from the temperature probe.

5. Press the temperature probe with the plastic screw connection into the installation location and screw in to the **limit stop of the 12-point sealing collar** (hand-tight), tightening torque 3 to 5 Nm.

**A new O-ring must be used after each dismantling process.**

When mounted, the following applies for the adapter screw fitting set:

- Max. operating temperature: 150 °C
- Pressure stage: PN16

## 2 Installation specifications for direct mounting

### 2.2 Brass screw connection

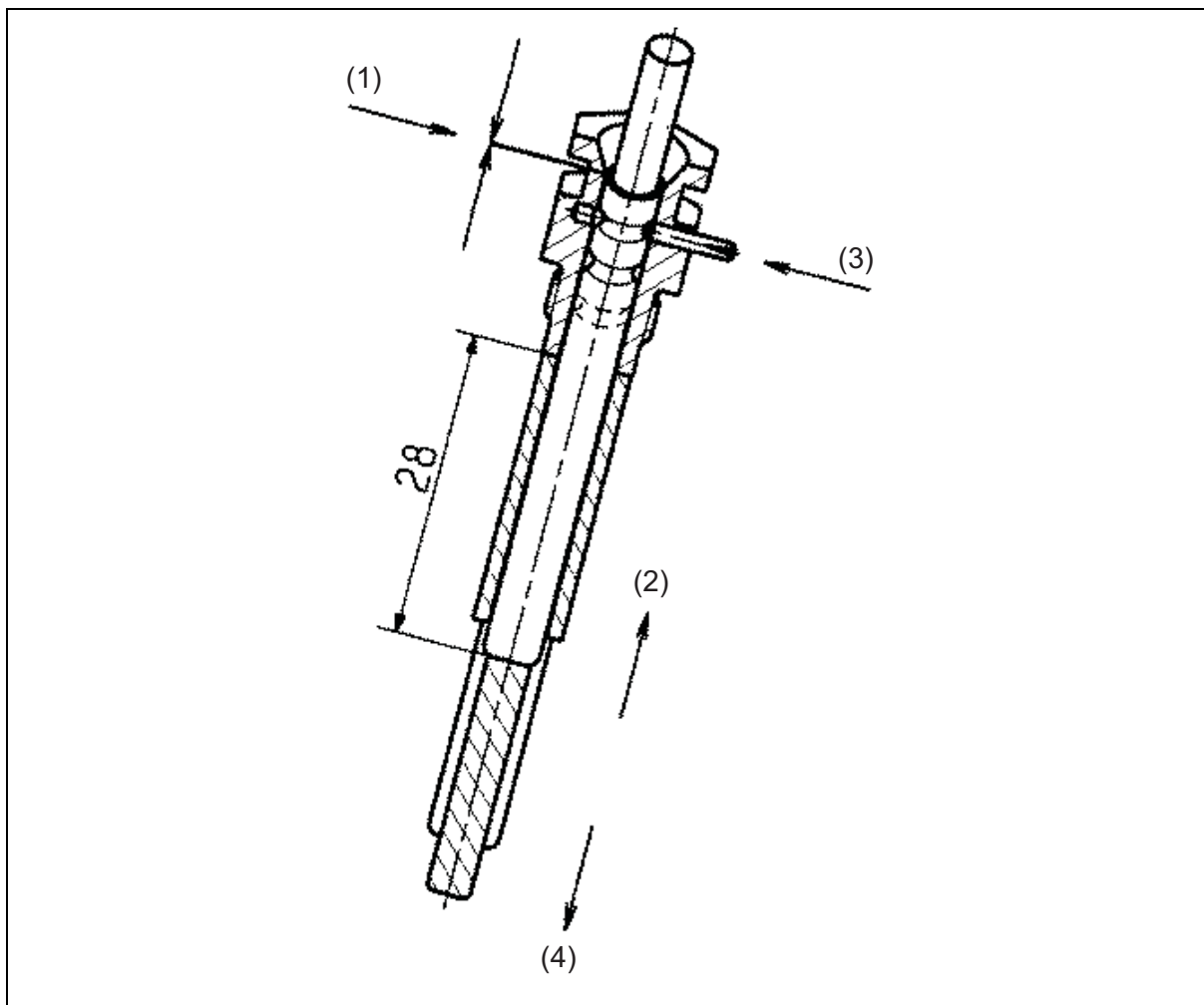

- (1) Brass screw connection
- (2) Assembly aid (depth stop for screw connection installation)
- (3) Slotted pin
- (4) Assembly aid (for positioning the O-ring)

#### Preparing for installation

1. Fit the brass screw connection in the correct position on the temperature probe using a loosely placed slotted pin.
2. Insert the back of the temperature probe into the assembly aid up to the limit stop (28 mm).
3. Press in the slotted pin until it is flush with the hexagonal surface (e.g., using a pair of pliers).
4. Remove the assembly aid.

## 2 Installation specifications for direct mounting

### Installation

In measuring point M10 x 1 according to EN 1434 (ball valve, T-piece, adapter screw fitting or heat meter housing)

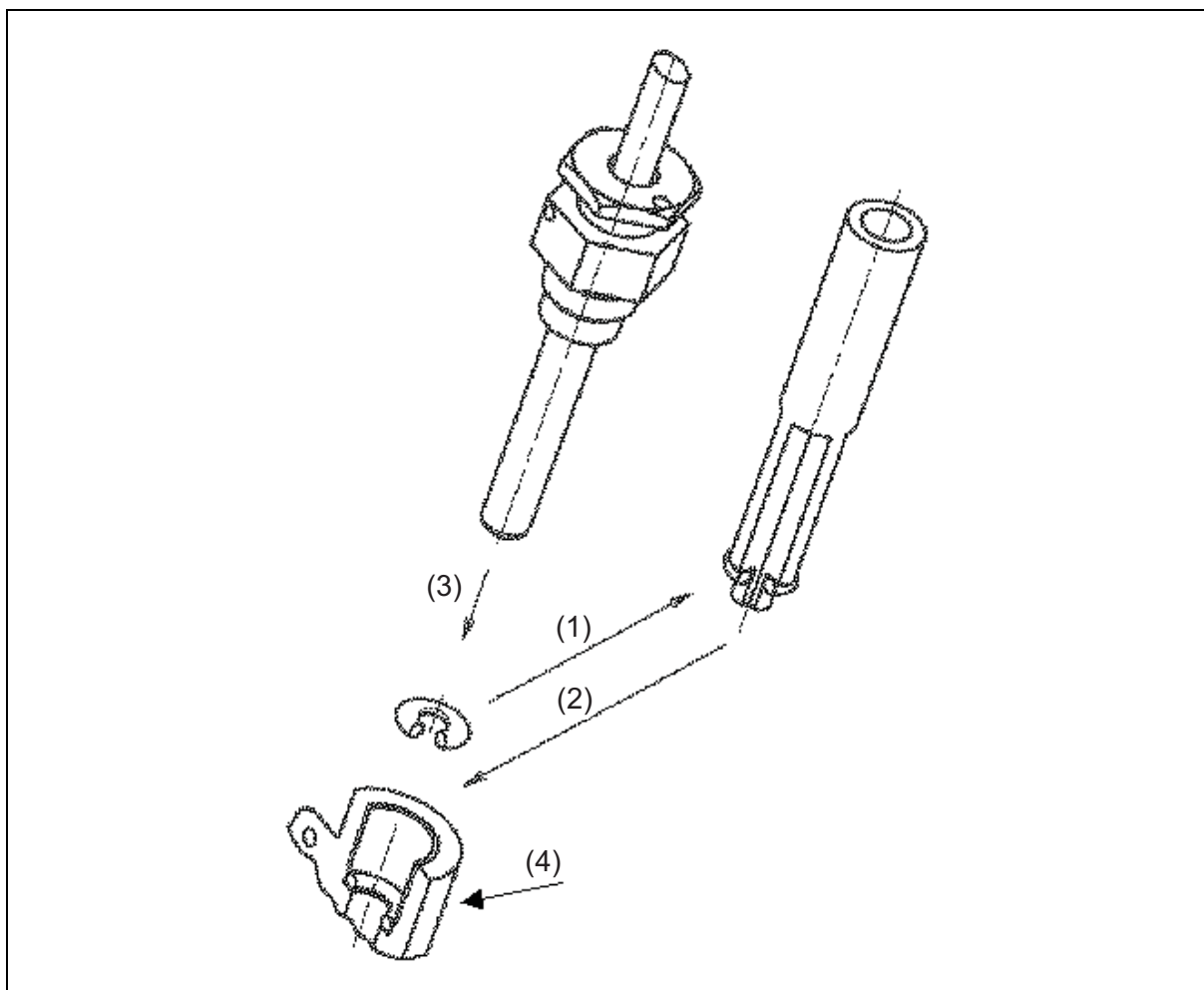

- (1) O-ring
- (2) Assembly aid
- (3) Temperature probe with screw connection
- (4) Measuring point according to EN 1434/M10 x 1

1. Place the O-ring onto the assembly aid.
2. Insert into the measuring point and remove the assembly aid.
3. Insert the temperature probe through the O-ring and into the measuring point and tighten the screw connection, tightening torque 3 to 5 Nm (when installed correctly, the bottom of the hexagon sits on top of the standard-compliant measuring point).

**A new O-ring must be used after each dismantling process.**

When mounted, the following applies for the adapter screw fitting set:

- Max. operating temperature: 150 °C
- Pressure stage: PN16

### 3 Installation specifications for immersion sleeve



**NOTE!**

Mounting in thermowell only with plastic screw connection.

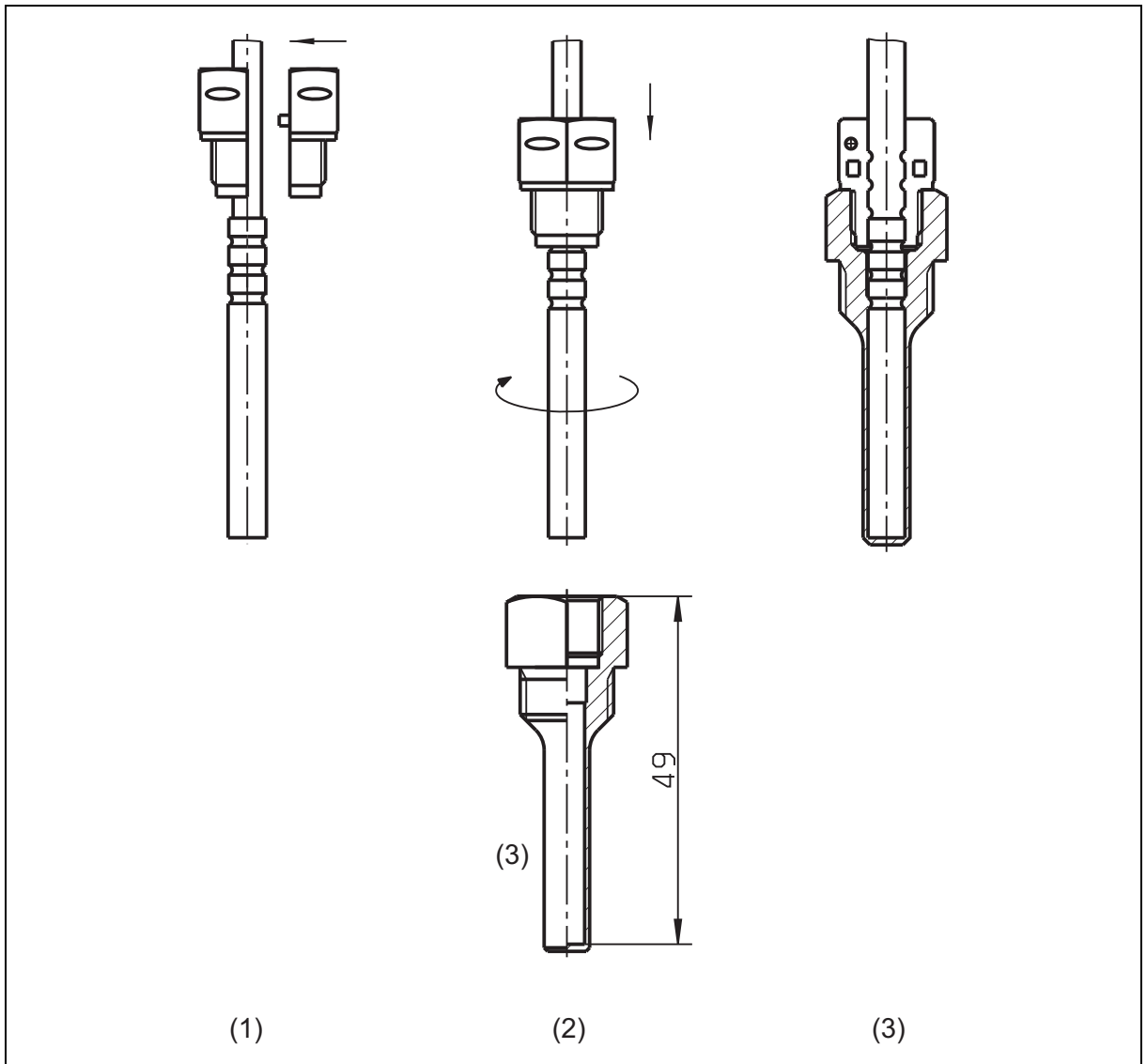

1. Pinch together the plastic screw connection on the probe cable.  
**Important:** Do **not** mount the plastic screw connection into the recesses (beading) on the temperature probe sleeve.
2. Push the plastic screw connection up to the probe tube. Screw the probe into the immersion sleeve.
3. Tighten the screw connection with a tightening torque of 3 to 5 Nm (hand-tight).  
Make sure that the probe is mounted securely in the immersion sleeve (probe tip must sit on the base of the immersion sleeve).





**JUMO GmbH & Co. KG**

Street address:  
Moritz-Juchheim-Straße 1  
36039 Fulda, Germany

Delivery address:  
Mackenrodtstraße 14  
36039 Fulda, Germany

Postal address:  
36035 Fulda, Germany

Phone: +49 661 6003-0  
Fax: +49 661 6003-607  
Email: [mail@jumo.net](mailto:mail@jumo.net)  
Internet: [www.jumo.net](http://www.jumo.net)

**JUMO Instrument Co. Ltd.**

JUMO House  
Temple Bank, Riverway  
Harlow, Essex CM 20 2DY, UK

Phone: +44 1279 63 55 33  
Fax: +44 1279 62 50 29  
Email: [sales@jumo.co.uk](mailto:sales@jumo.co.uk)  
Internet: [www.jumo.co.uk](http://www.jumo.co.uk)

**JUMO Process Control, Inc.**

6733 Myers Road  
East Syracuse, NY 13057, USA

Phone: +1 315 437 5866  
Fax: +1 315 437 5860  
Email: [info.us@jumo.net](mailto:info.us@jumo.net)  
Internet: [www.jumousa.com](http://www.jumousa.com)

