

JUMO DELOS S02

Pressure transmitter with display



Bluetooth®



Single Pair Ethernet

Operating manual



40505612T90Z001K000

V3.00/EN/30052944/2025-04-02

Further information and downloads



qr-405056-en.jumo.info

Table of contents

1	About this documentation	6
1.1	Validity	6
1.2	Purpose	6
1.3	Target group	6
1.4	Abbreviations	6
1.5	Definition of terms	7
1.6	Trademark information	7
1.7	Symbols	7
2	Safety	8
2.1	Intended use	8
2.2	Qualification of personnel	8
2.3	Hot media	8
2.4	Hazardous materials	8
2.5	Mechanical loads	9
2.6	Transport and storage damage	9
3	Description	10
3.1	Structure	10
3.2	Functions	10
3.3	Nameplate	11
3.4	Approval marks and certificates	12
3.5	Scope of delivery	12
4	Technical data	13
4.1	Electrical safety	13
4.2	Electrical data	13
4.3	Inputs	14
4.3.1	Measurands	14
4.4	Outputs	15
4.5	Interfaces	16
4.5.1	Bluetooth	16
4.5.2	SPE	16
4.6	Display	16
4.7	Environmental influences	17
4.8	Mechanical features	18
4.8.1	Materials	18
4.8.2	Surface finish	18
4.8.3	Device	19
4.8.4	Sensor	19

Table of contents

4.8.5	Process connections	19
4.9	Dimensions	20
4.9.1	Device in standard version	20
4.9.2	Device with increased medium temperature	21
4.9.3	Process connections	22
5	Installation	25
5.1	Preparing for installation	25
5.1.1	Installation site	25
5.1.2	Admissible process pressure	25
5.1.3	Installation position	25
5.1.4	Measurement set-up	25
5.2	Important information for usage according to EHEDG	27
5.3	Installing the device	28
6	Electrical connection	29
6.1	Terminal assignment	29
6.1.1	Terminal assignment, M12 connector, SPE	29
6.2	Connecting the device	30
7	Startup	31
7.1	Zero point adjustment	31
8	Operation	32
8.1	Device info display	32
8.2	Basic status	32
8.2.1	Device status display	32
8.2.2	Process value display	32
8.2.3	Text line	33
8.2.4	Toolbar	33
8.3	Error messages	33
9	Interfaces	34
9.1	Bluetooth	34
9.1.1	App download	34
9.1.2	Authentication	34
9.1.3	Connection	35
9.1.4	Bluetooth settings	35
9.1.5	JUMO smartCONNECT app	35
9.2	JUMO Cloud	36
9.2.1	Data exchange	36

Table of contents

9.2.2	Startup	37
9.2.3	Further information	37
9.3	Modbus TCP	37
9.3.1	Transmission	37
9.3.2	Modbus address tables	37
10	Configuration	38
10.1	Display on the device	38
10.2	Interfaces	38
10.2.1	Bluetooth	38
10.2.2	Single Pair Ethernet	39
10.3	Pressure measurand	40
10.4	Functions	40
10.4.1	Limit value monitoring function	40
11	Modbus address tables	44
11.1	Transmission	44
11.2	Version and fabrication number	44
11.3	Configuration	44
11.4	Actions	47
11.5	Process values	47
11.6	Error	48
11.7	Analog selector	48
12	Troubleshooting	49
12.1	Process value error	49
12.2	Error messages	49
13	Maintenance and cleaning	51
13.1	Maintenance	51
13.2	Cleaning	51
13.2.1	Cleaning device housing	51
13.2.2	Clean measurement membrane	51
14	Shutdown	52
14.1	Dismounting	52
14.2	Returns	52
14.3	Disposal	52
15	Accessories	53
16	Open-source software	54

1 About this documentation

1.1 Validity

This manual is valid for all devices with an SPE interface (Single Pair Ethernet).

1.2 Purpose

This documentation is part of the device and includes all information to ensure that it is used safely and as intended across all phases of the product lifecycle.

If you do not follow the documentation and safety information, this may result in risk to life and damage to property due to improper use.

- Read and follow the documentation and the safety information and warnings.
- Store the document in its entirety, in an easily accessible location, and so that it can be read in full at all times.
- Contact the manufacturer if you have any questions about the device and documentation.

1.3 Target group

This documentation is intended to be used by personnel for plant mechanical systems for sanitary, heating and air-conditioning technology, electrical engineering or mechanical and plant engineering.

1.4 Abbreviations

abs	Absolute pressure
CE	Conformité Européenne (European Conformity)
CIP	Cleaning in Place (Process for cleaning process plants without major disassembly)
DHCP	Dynamic Host Configuration Protocol (communication protocol for automatic assignment of the network configuration)
DMC	Data Matrix Code
DN	Diamètre Nominal (nominal diameter)
DNS	Domain Name System
EHEDG	European Hygienic Engineering and Design Group (association of equipment suppliers for food production, companies involved in food processing, research institutes, and public health organizations as a foundation)
EMC	Electromagnetic compatibility
FCC	Federal Communications Commission (issues FCC certification for electronic products sold or manufactured in the United States)
FDA	Food and Drug Administration (US-amerikanische Arzneimittelbehörde; zuständig für Zulassung, Kontrolle und Überwachung unter anderem von Medizinprodukten in den Vereinigten Staaten)
LVS	Limit Value Switch
IP	Internet Protocol
MQTT	Message Queuing Telemetry Transport (network protocol for exchanging data between Internet of Things (IoT) devices and other applications)
MSP	Measuring span (difference between measuring range end and measuring range start)
NFC	Near Field Communication
NPT	National Pipe Thread (thread standard used in the USA for self-sealing compression fittings)
PDU	Protocol Data Unit (core component of the Modbus telegram; consisting of function code and data)
PELV	Protective Extra Low Voltage

1 About this documentation

PoDL	Power over Data Line (power is supplied in parallel to data transmission via the single-pair Ethernet connection)
rel	Relative pressure
SCCP	Serial Communication Classification Protocol (automatic negotiation of the PoDL class)
SPE	Single Pair Ethernet
SPS	Programmable Logic Controller
TCP	Transmission Control Protocol (standard for network conversation)
UKCA	UK Conformity Assessed
UNF	Unified Fine Thread Standard (American imperial standard fine thread)
URL	Uniform Resource Locator (denotes an address that specifies a file on a server)

1.5 Definition of terms

Use in the documentation	Definition
Device, product	Pressure transmitter
Medium, measurement medium	Gases, vapors, liquids
Product lifecycle	Overall consideration of Product identification, acceptance of the goods, storage, mounting, connection, operation, troubleshooting, maintenance to disposal

1.6 Trademark information

All trademarks and trade and company names used are the property of their rightful owners or authors.

1.7 Symbols



WARNING!

The signal word **"WARNING"** indicates an imminent danger.

Non-observance can lead to death or serious injury.

- ▶ The instructions in the warning notice must be observed and followed!
-



NOTE!

This symbol refers to important information about the device or its handling.



REFERENCE!

This symbol refers to **further information** in other sections, chapters, or other manuals.

2 Safety

2.1 Intended use

The pressure transmitter with display measures the absolute or relative pressure of liquid, vaporous, and gaseous media.

The device is suitable for mounting in pipes and containers in various applications. It is mounted using individual process connections.

In order to ensure the device's perfect condition, only media may be used to which the materials in contact with the media are sufficiently resistant.

The operator is responsible for compliance with the specifications indicated in the technical data (e.g. operating and ambient temperature).

The device may only be used in a technically perfect condition, in accordance with its intended use, in a safety-conscious and hazard-conscious manner and in compliance with the operating manual.

The following in particular are considered to be improper

- Any structural, technical or electrical modifications to the device.
- Use of the device outside the areas described in this operating manual.
- Use of the device deviating from the technical data.

The manufacturer is not liable for any damage resulting from improper use.

The documentation is part of the device. The device is only intended for use according to this documentation.

2.2 Qualification of personnel

The personnel deployed must meet the following requirements in all phases of the product lifecycle:

- Members of personnel have at least completed training in the field of plant mechanical systems for sanitary, heating, and air-conditioning technology or have completed a degree in electrical engineering or mechanical and plant engineering.
- Members of personnel are familiar with this documentation and the safety information and warnings it contains.

2.3 Hot media

Hot media may result in the device surfaces becoming hot and presenting a risk of injury.

- Allow the device and plant to cool down.
- Wear suitable protective equipment.
- If required, install contact protection.

2.4 Hazardous materials

Using hazardous materials as a medium may result in abrasive and corrosive damage to components of the product that come into contact with the medium. The medium may leak and present a fire hazard and a risk to health.

Carry out a risk assessment taking into consideration the safety data sheet for the relevant hazardous substance for mounting, operation, maintenance, cleaning, and disposal:

- Comparison and systematic checking of the durability of the components of the product that come into contact with the medium and the admissible environmental influences.
- Assessment of the risk to people and the environment.
- Assessment of the fire hazard due to the product materials, the admissible environmental influences, and the voltage supply.

2.5 Mechanical loads

Mechanical load on the device and process connections can lead to leaks.

- Do not place the device and the process connections under mechanical strain.
- Systematically check that the process connections are leak-tight.

2.6 Transport and storage damage

The device can be damaged if it is insufficiently protected during transport and/or improperly stored.

- Transport the device protected from moisture and dirt in shockproof packaging.
- Protect all electrical and mechanical connections from damage.
- Observe the admissible storage temperature of the device.
- Store the device in a dry and dust-free environment.

3 Description

3.1 Structure



- 1 Display
- 2 M12 connector
- 3 Pressure compensation element (only with "relative pressure" version)
- 4 Housing for electronic components
- 5 Process connection

3.2 Functions











The process pressure has an effect on the piezoresistive sensor element via the metallic pressure measurement membrane. Deformation of the membrane and the sensor element occurs due to the application of force; this results in a change in resistance. In addition, there is the mechanical tension that comes about as the result of the deformation in the sensor element's piezoresistive material. This results in a change in the electrical conductivity. In turn, this change in conductivity results in a change in resistance.

This change in resistance in the sensor element is converted into a corresponding output signal and output as a measured value.

The pressure measuring cell is open to the atmosphere via the pressure compensation element in the "relative pressure" version. The ambient pressure in the pressure measuring cell can therefore be acquired and compensated.

The pressure measuring cell is encapsulated in the "absolute pressure" version. The process pressure is measured compared to the vacuum.

3.3 Nameplate

	Manufacturer and address
DELOS S02	Device designation
Typ	Device version
TN	Part no.
	Measuring range
	Voltage supply
	Output
F-Nr.	Fabrication number The production date (year/week) can be taken from the serial number. These are the characters 12, 13, 14, 15.
	CE identification marking
	DMC code
	UKCA identification marking
	FCC identification marking
	UL identification marking
	Disposal
	Observe device documentation!

3 Description

3.4 Approval marks and certificates



Certificates for approved device versions are available for download on the manufacturer's website.

Submitted:



EHEDG conformity only in conjunction with EHEDG-approved process connections, ⇨ page 24.

Radio Equipment Directive (RED)

JUMO GmbH & Co. KG hereby states that the DELOS S02 device complies with the Directive 2014/53/EU. The full text of the EU Declaration of Conformity is available at the following web address: qr-405056-en.jumo.info.

Radio Equipment Regulations 2017

JUMO GmbH & Co. KG hereby states that the DELOS S02 device complies with the radio equipment regulations UK S.I. 2017 No. 1206. The full text of the UK Declaration of Conformity is available at the following web address: qr-405056-en.jumo.info.

Federal Communications Commission (FCC)

This device complies with part 15 of the FCC rules. Operation is subject to the following two conditions.

- (1) This device may not cause harmful interference.
- (2) This device must accept any interference received, including interference that may cause undesired operation.

Caution: Any Changes or modifications not expressly approved by the party responsible for compliance could void the user's authority to operate the equipment.

3.5 Scope of delivery

Device in the ordered version
Operating manual

4.1 Electrical safety

Requirements	DIN EN 61010-1:2020 The device must be equipped with an electrical circuit that meets the requirements for "Limited-energy circuits".
--------------	--

4.2 Electrical data

Voltage supply	DC 18 to 30 V, PELV
Current consumption	≤ 100 mA
Power consumption	≤ 1.8 W
Overvoltage category	II
Pollution degree	2
Protection rating	DIN EN 61140, Class III (protective low voltage)
PoDL class	Class 11, IEEE 802.3cg
PoDL classification	SCCP or Forced Mode
Electrical connection	
Connection element	M12 plug connection
M12 plug connector	IEC 63171-5
Version	2-pole
Connecting cable	IEC 61156-13, IEC 61156-14
Version	2-core, shielded
Bandwidth	≥ 20 MHz
Line length	≤ 500 m (\geq AWG 22 at \geq DC 24 V supply voltage into the cable)
DC loop resistance	< 59 Ω
Temperature resistance	≥ 80 °C
For UL application	
Approved cables ^a	CYJV2/8, CYJV/7, PVVA2/8, PVVA/7

^a The cables must be suitable for the voltage, current and temperature used.

4 Technical data

4.3 Inputs

4.3.1 Measurands

Reference conditions

Basic principles	EN 61298-1, DIN 16086, DIN EN 60770
Installation position	Any
Calibration position	Device upright, process connection at the bottom

Relative pressure

Measuring range bar	Linearity ^a % MSP ^e	Accuracy with		Long-term stability % MSP per year	Overload capability ^b bar	Burst pressure bar
		20 °C ^c % MSP	-20 to +75 °C ^d % MSP			
0 to 0.4 ^f	0.15	0.40	1.00	≤ 0.15	10	20
0 to 1 ^f	0.15	0.30	1.00	≤ 0.15	10	20
0 to 4	0.10	0.25	0.75	≤ 0.10	25	50
0 to 10	0.10	0.25	0.75	≤ 0.10	50	60
0 to 25	0.10	0.25	0.75	≤ 0.10	120	200
0 to 60	0.10	0.25	0.75	≤ 0.10	300	400
0 to 100	0.10	0.25	0.75	≤ 0.10	300	400
-0.1 to +0.1 ^f	0.20	0.50	1.00	≤ 0.20	6	10
-0.4 to +0.4 ^f	0.15	0.40	1.00	≤ 0.20	10	20
-1 to +1 ^f	0.15	0.30	1.00	≤ 0.15	10	20
-1 to +3	0.10	0.25	0.75	≤ 0.10	25	50
-1 to +9	0.10	0.25	0.75	≤ 0.10	50	60
-1 to +24	0.10	0.25	0.75	≤ 0.10	120	200

^a According to limit point setting.

^b All pressure transmitters are vacuum proof.

^c Includes: linearity, hysteresis, repeatability, deviation of measuring range start value and measuring range end value.

^d Includes: linearity, hysteresis, repeatability, deviation of measuring range start value and measuring range end value, thermal effect on measuring range start and measuring span.

^e MSP = measuring span.

^f Not for increased medium temperature.

Absolute pressure

Measuring range bar	Linearity ^a % MSP ^e	Accuracy with		Long-term stability % MSP per year	Overload capability ^b bar	Burst pressure bar
		20 °C ^c % MSP	-20 to +75 °C ^d % MSP			
0 to 0.4 ^f	0.15	0.40	1.00	≤ 0.15	10	20
0 to 1 ^f	0.15	0.30	1.00	≤ 0.15	10	20
0 to 4	0.10	0.25	0.75	≤ 0.10	25	50
0 to 10	0.10	0.25	0.75	≤ 0.10	50	60
0 to 25	0.10	0.25	0.75	≤ 0.10	120	200
0 to 60	0.10	0.25	0.75	≤ 0.10	200	300

^a According to limit point setting.

^b All pressure transmitters are vacuum proof.

^c Includes: linearity, hysteresis, repeatability, deviation of measuring range start value and measuring range end value.

^d Includes: linearity, hysteresis, repeatability, deviation of measuring range start value and measuring range end value, thermal effect on measuring range start and measuring span.

^e MSP = measuring span.

^f Not for increased medium temperature.

4.4 Outputs

Measuring range scaling (turn down)	1:4
Warm-up time	75 s
Step response time T ₉₀	150 ms

4 Technical data

4.5 Interfaces

4.5.1 Bluetooth

Function	Transfer of configuration data and device information, display of process values
Communication	Via end device with JUMO smartCONNECT app
Authentication	Via Bluetooth® radio module and NFC tag
Connection status (configurable)	
Permanently	Active
Temporarily	Restricted (via NFC)
Range	10 m under reference conditions
Radio frequency	
Bluetooth® radio module	2.4 GHz
NFC tag	13.56 MHz
Max. transmission power	
Bluetooth® radio module	0 dBm
NFC tag	–
JUMO smartCONNECT app	
System requirements	
iOS device	iPhone 7 or later (recommended) with iOS 13
Android device	Android 8.0 or later

4.5.2 SPE

Function	Transfer of process data, configuration data, and device information, voltage supply via PoDL
Communication	Via end device and JUMO Cloud, via Modbus master
SPE standard	10BASE-T1L
Transmission protocol	Integrated JUMO Cloud gateway, Modbus TCP
Data transfer rate	10 Mbit/s

4.6 Display

Type	LCD
Display range	22.5 × 26.0 mm
Resolution	
Process value display	18-segment
Text line	5 × 8 Dot-Matrix
Brightness	11 levels (configurable)
Alignment	0°, 180°

4.7 Environmental influences

The product is UL-approved. The approval stipulates that the product may be used indoors only.

Admissible temperatures	DIN 60068-2-1, DIN 60068-2-2
Medium	
Standard	-25 to +100 °C (135 °C maximum 1 hour per day without function)
Increased	-25 to +200 °C
H2 ready	-40 to +120 °C
Ambient	-25 to +75 °C
Storage	-40 to +85 °C
Climatic conditions	DIN EN 60721-3-3
Climate class	3K6
Air temperature	-25 to +55 °C
Relative humidity	
Storage	≤ 90 %
Operation	≤ 100 % – condensation on device outer shell
Protection type	DIN EN 60529 IP65, IP67
Electromagnetic compatibility (EMC)	DIN EN 61326-2-3:2022
Interference emission	Class B ^a
Interference immunity	Industrial requirements
Oscillation	DIN EN 60068-2-6
Amplitude	1.5 mm at 10 to 2000 Hz
Acceleration	20 g at 10 to 2000 Hz
Shock	DIN EN 60068-2-27 50 g for 11 ms, 100 g for 1 ms
Site altitude	≤ 2000 m above sea level

^a The product is suitable for industrial use as well as for households and small businesses.

4 Technical data

4.8 Mechanical features

4.8.1 Materials

Housing	
Top section of the housing	PBT-GF30
Case bottom section	1.4301 (304), PBT-GF30
Threaded sleeve M12 x 1	1.4301 (304)
Seal	EPDM
Display	PMMA
Sensor	Silicon
Membrane	1.4435 (316L)
Filling oil	Silicone oil, FDA-compliant oil
Process connection	
Without EHEDG certification	1.4571 (316Ti)
With EHEDG certification	1.4404 (316L)
Welding ring	1.4404 (316L)
O-ring, sealing ring	FPM, others available as an optional extra (e.g. EPDM, VMQ)

4.8.2 Surface finish

Wetted parts

Process connection	
Front-flush	
Taper socket with grooved union nut DN 25, DIN 11851	Ra ≤ 0,8 µm, Ra ≤ 0,4 µm on request
Taper socket with grooved union nut DN 40, DIN 11851	Ra ≤ 0,8 µm, Ra ≤ 0,4 µm on request
Clamping socket (clamp) DN 10/15/20, DIN 32676	Ra ≤ 0,8 µm, Ra ≤ 0,4 µm on request
Tank connection with grooved union nut DN 25 round thread 52 × 1/6 (dairy pipe fitting)	Ra ≤ 0,8 µm
Front-flush, with EHEDG certification	
Clamping socket (clamp) DN 25/32/40, DIN 32676	Ra ≤ 0,8 µm, Ra ≤ 0,4 µm on request
Clamping socket (clamp) DN 50, DIN 32676, 2" ISO 2852	Ra ≤ 0,8 µm, Ra ≤ 0,4 µm on request
JUMO PEKA Hygienic process connection	Ra ≤ 0,8 µm

4.8.3 Device

Weight ^a Process connection G 1/4	~ 155 g
Alignment Top section of the housing	Can be rotated by 330°

^a Depends on version and DN.

4.8.4 Sensor

Measuring principle	Piezoresistive (absolute pressure sensor, relative pressure sensor)
Admissible load changes	> 10 million

4.8.5 Process connections

Specifications according to DIN standard in accordance with intended use. Temperature range depends on pressure range and sealing material.

Front-flush

Designation	Max. pressure	Temperature range
G 3/4 front-flush DIN EN ISO 228-1	25 bar	-10 to +150 °C
	40 bar	-10 to +100 °C
G 1/2 front-flush with double seal	25 bar	-10 to +150 °C
	40 bar	-10 to +100 °C
G 3/4 front-flush with double seal	25 bar	-10 to +150 °C
	40 bar	-10 to +100 °C
G 1 front-flush with double seal	40 bar	-10 to +100 °C
Taper socket with grooved union nut DN 25 DIN 11851	40 bar	-10 to +140 °C
Taper socket with grooved union nut DN 40 DIN 11851	40 bar	-10 to +140 °C
Clamping socket (clamp) DN 10/15/20 DIN 32676	25 bar	-10 to +140 °C
Tank connection with grooved union nut DN 25 round thread 52 × 1/6 (dairy pipe fitting)	25 bar	Up to 150 °C
	40 bar	Up to 100 °C

4 Technical data

Front-flush, with EHEDG certification

Designation	Max. pressure	Temperature range
Clamping socket (clamp) DN 25/32/40 DIN 32676	25 bar	-10 to +140 °C
Clamping socket (clamp) DN 50 DIN 32676, 2" ISO 2852	16 bar	-10 to +140 °C
JUMO PEKA Hygienic process connection	25 bar	-10 to +200 °C
	40 bar	-10 to +100 °C

4.9 Dimensions

4.9.1 Device in standard version

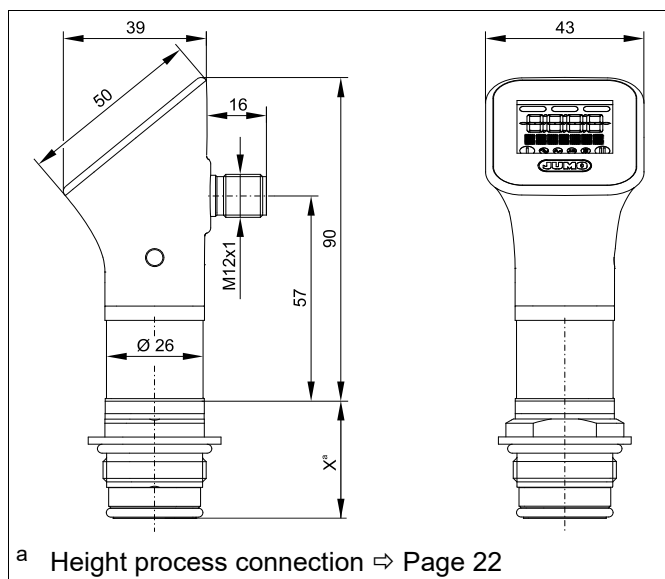

4.9.2 Device with increased medium temperature

Not front-flush

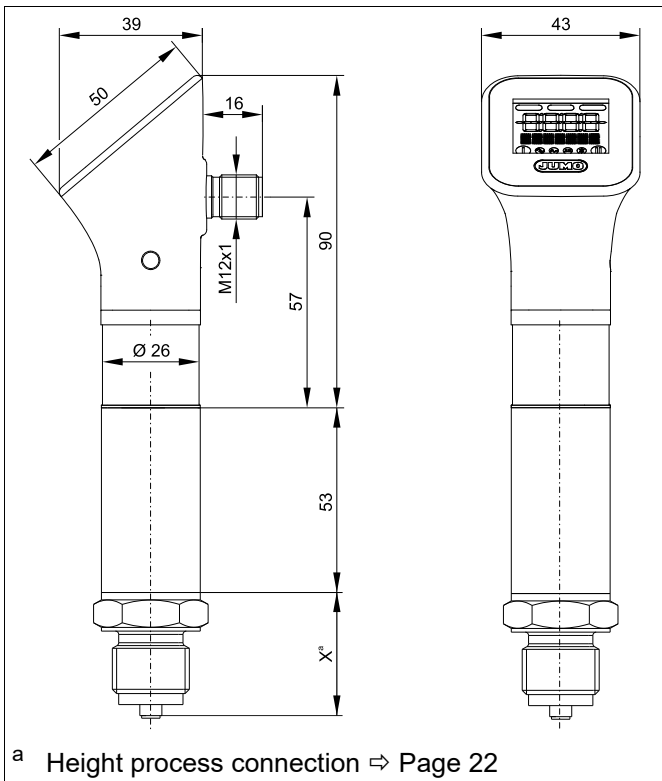

Front-flush

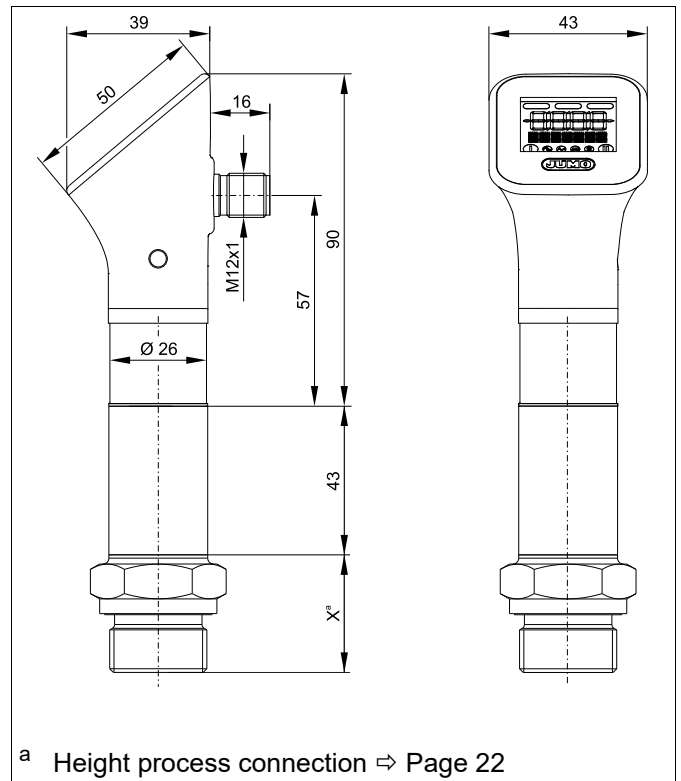

Front-flush, with EHEDG certification

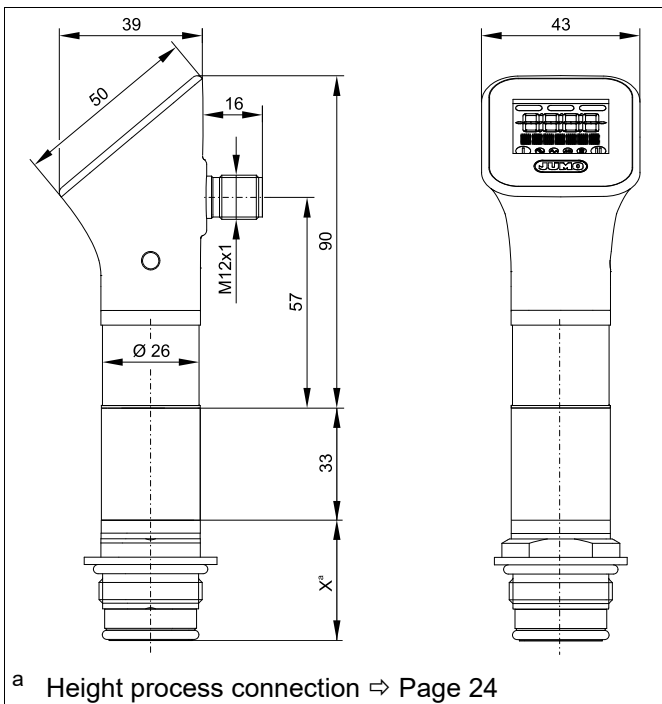

4 Technical data

4.9.3 Process connections

Not front-flush

G 1/2 DIN EN 837

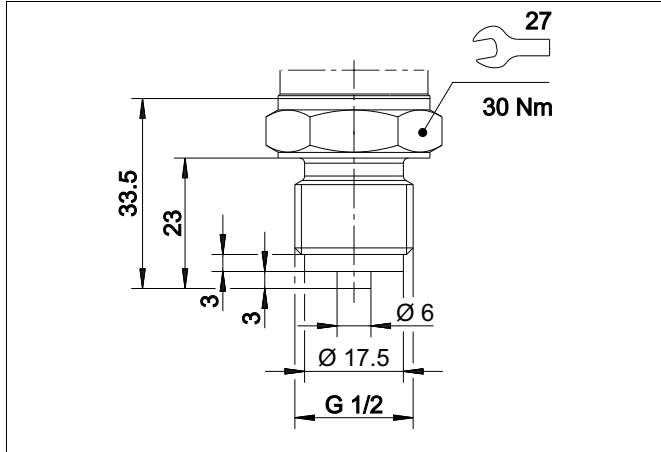

1/4" – 18 NPT DIN EN 837

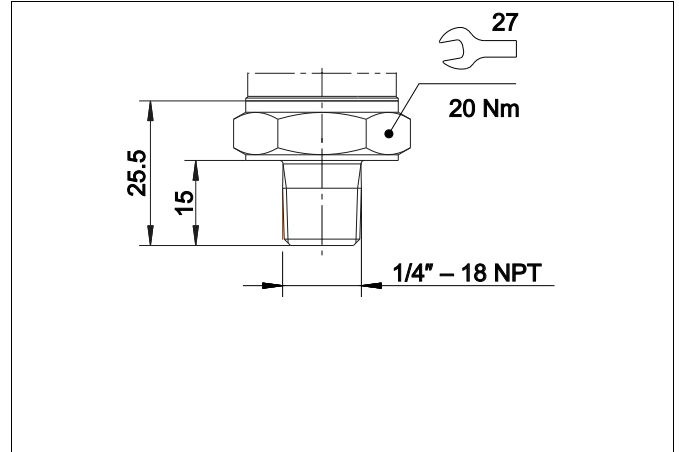

G 1/4 DIN EN 3852-11

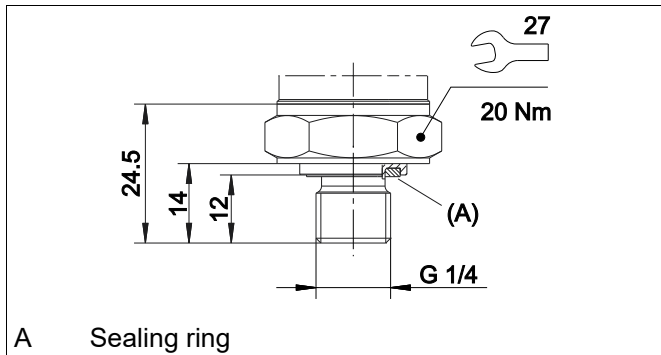

G 1/2 DIN EN 3852-11

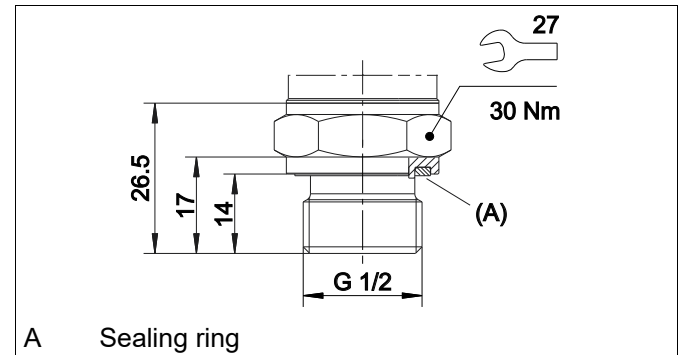

Front-flush

G 3/4 front-flush DIN EN ISO 228-1

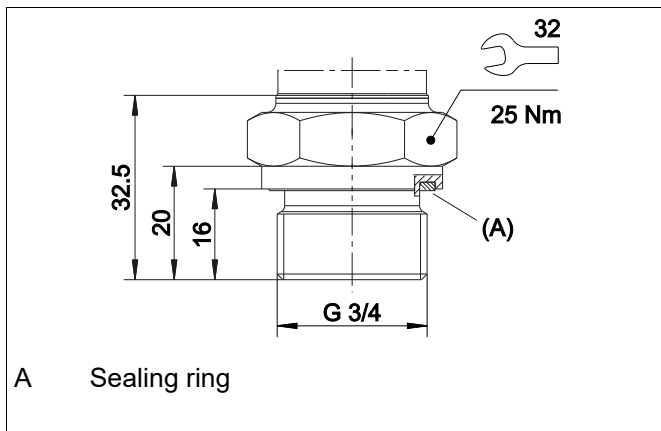

G 1/2 front-flush with double seal

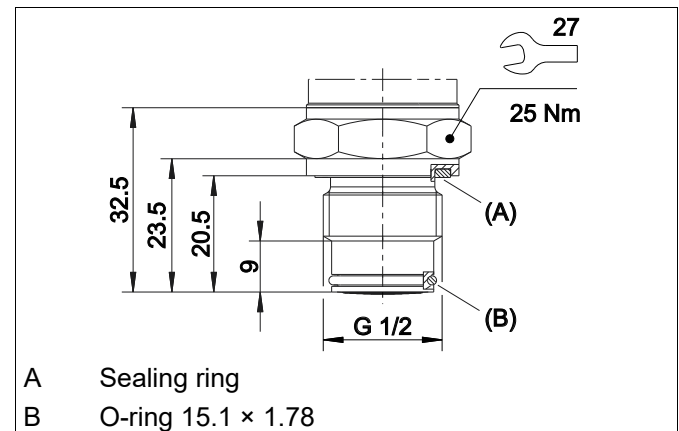

4 Technical data

G 3/4 front-flush with double seal

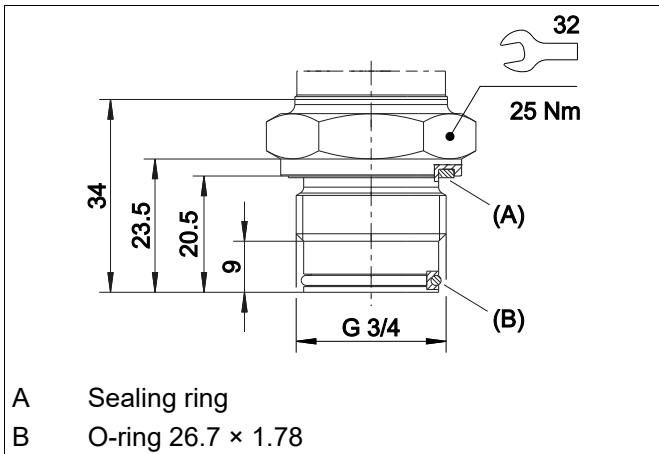

G 1 front-flush with double seal

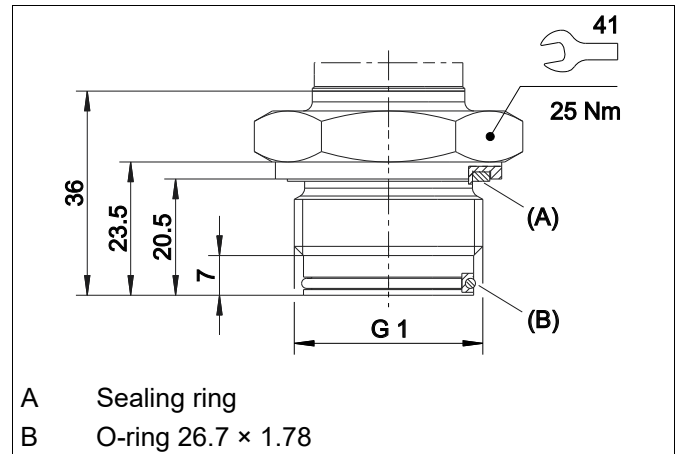

Taper socket with grooved union nut, DN 25
DIN 11851

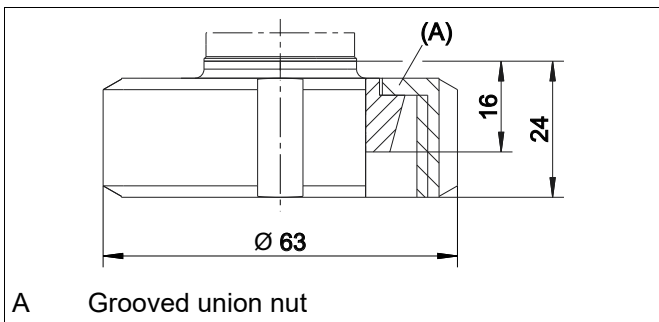

Taper socket with grooved union nut, DN 40
DIN 11851

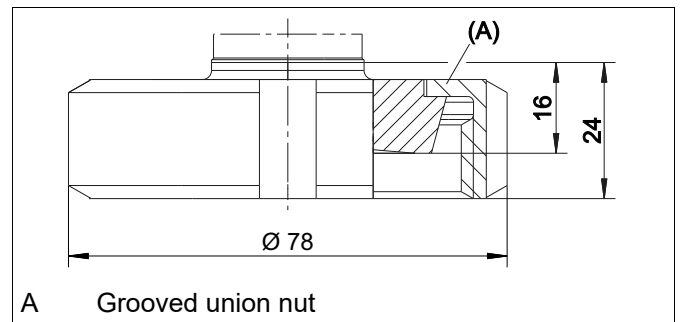

Clamping socket (clamp) DN 10/15/20
DIN 32676

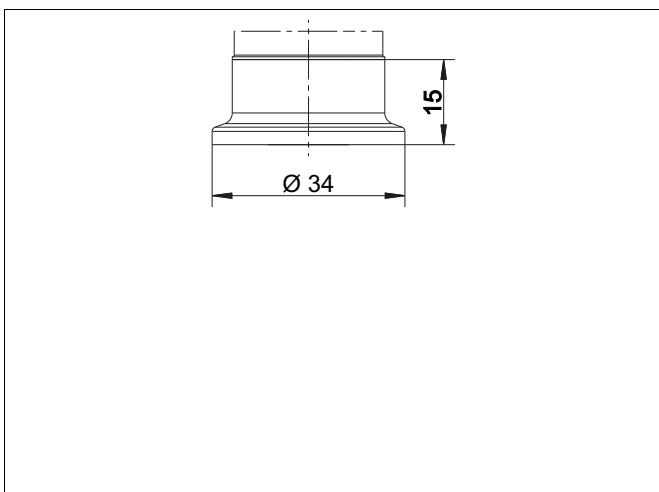

Tank connection with grooved union nut, DN 25
Round thread 52 × 1/6 (dairy pipe fitting)

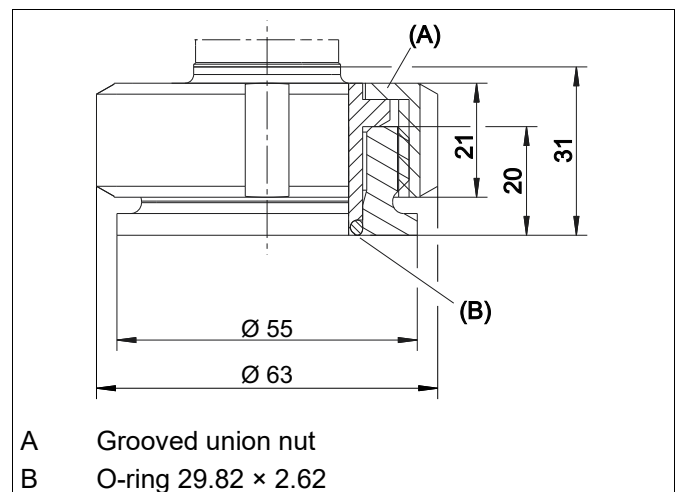

4 Technical data

Front-flush, with EHEDG certification

Clamping socket (clamp) DN 25/32/40
DIN 32676

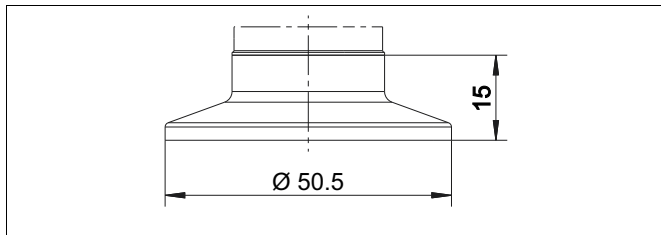

Clamping socket (clamp) DN 50
DIN 32676, 2" ISO 2852

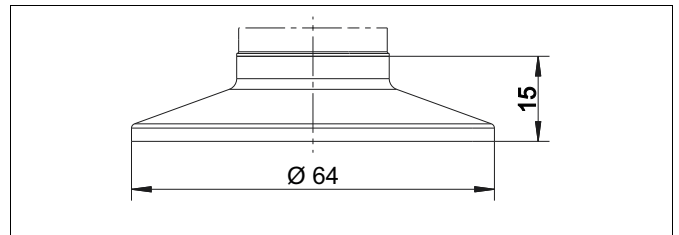

JUMO PEKA

Hygienic process connection

⇒ [Data sheet 409711](#)

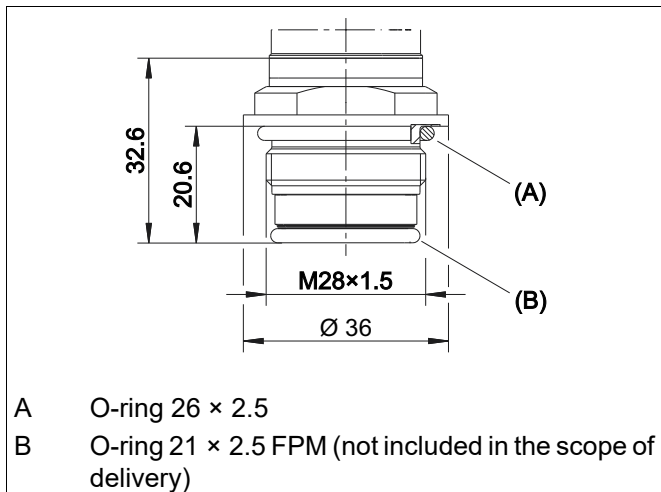



NOTE!

Ensure the compatibility of the device and measurement medium before installation.

5.1 Preparing for installation

5.1.1 Installation site

- ✓ The device is protected from UV radiation.
- ✓ The device is protected from the weather when used outside.
- ✓ The admissible environmental influences must be observed ⇒ "Environmental influences ", Page 17.

5.1.2 Admissible process pressure

The process pressure admissible for the device is specified on the nameplate. It is valid at a reference temperature of 20 °C.

5.1.3 Installation position

The device can be installed in any position.

Upright installation of the device (as shown) is recommended.



In order to ensure readability of the display in all installation positions, the display orientation can be rotated by 180° using the app or software. In addition, you can rotate the housing on the sensor by $\pm 165^\circ$.

5.1.4 Measurement set-up

Gases

Mount the device above the measuring point for pressure measurement in gases. Any condensate can therefore flow into the pipe.

5 Installation

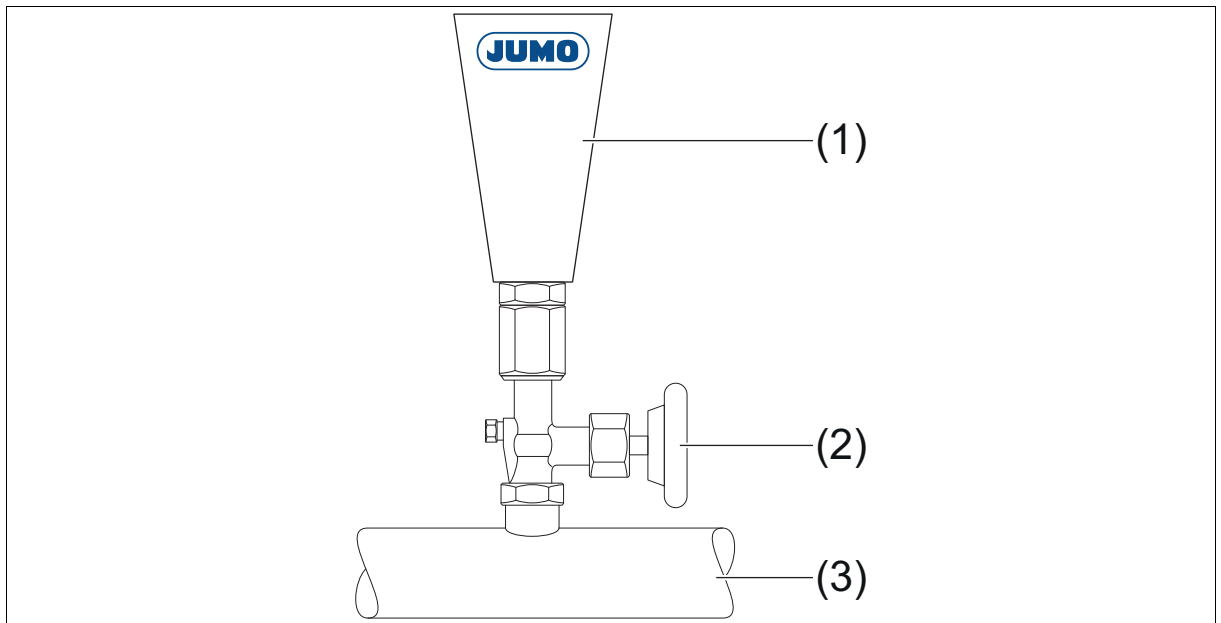

- 1 Device
- 2 Shut-off valve
- 3 Pipe

Steam

Use a siphon for pressure measurement in steam. The device is protected against excessive temperatures thanks to the condensate in the pipe bend.

The device can be mounted above or below the measuring point. Installation below is recommended.

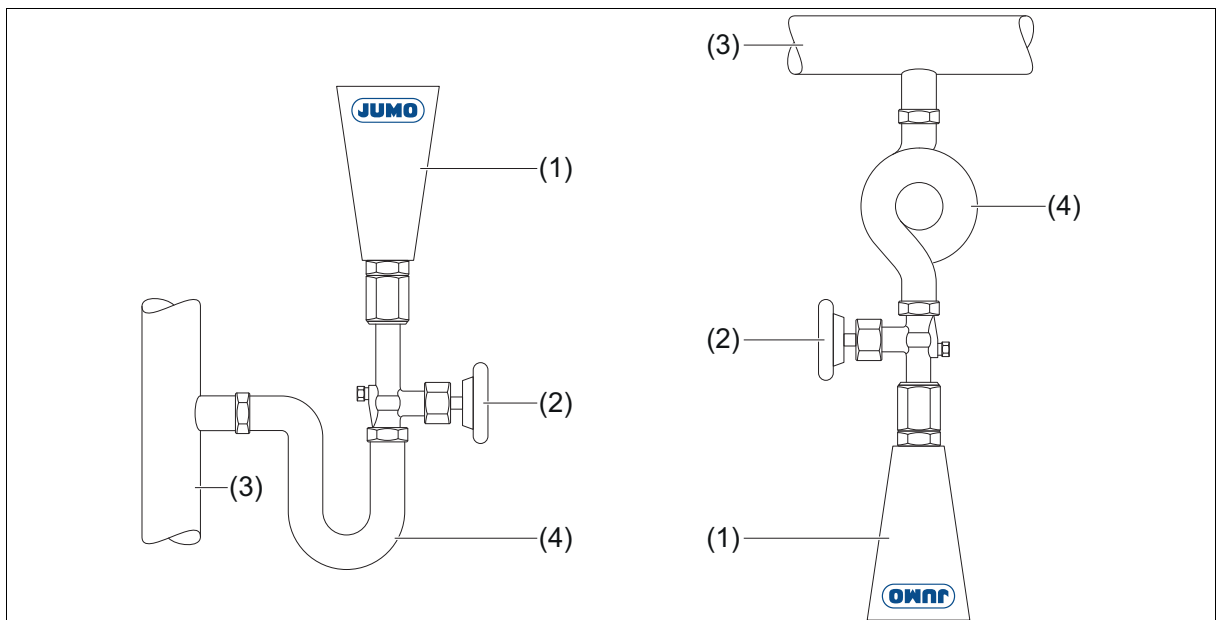

- 1 Device
- 2 Shut-off valve
- 3 Pipe
- 4 Siphon

Liquids

The device can be mounted above or below the measuring point. Installation below is recommended.

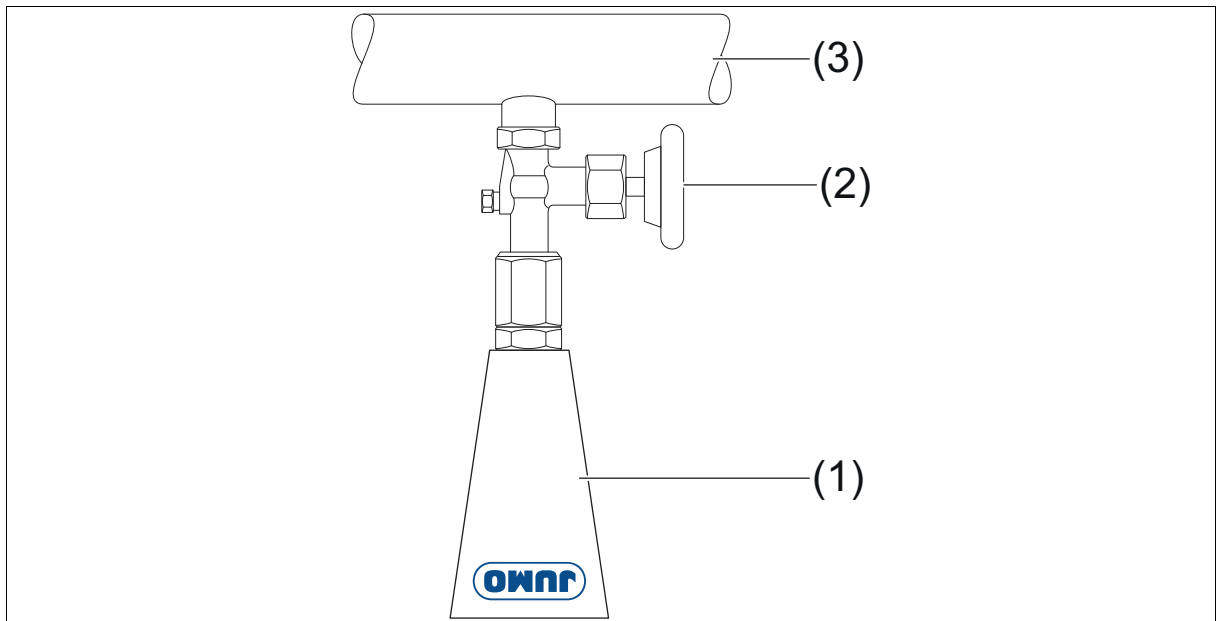

- 1 Device
- 2 Shut-off valve
- 3 Pipe

5.2 Important information for usage according to EHEDG

The device in combination with one of the following process connections is suitable for use in food production due to its EHEDG approval:

- Clamp connections DN 25, DN 32, DN 40, DN 50, DN 100 or 1", 1 1/2", 2 1/2", 4" with Tri-Clamp seal Combifit International B.V.
- JUMO PEKA with FKM O-ring
- VARINLINE® housing with process connection type N or type G with EPDM O-ring
- VARIVENT® process connections type B, type F, and type N with EPDM O-ring
- Aseptic screw connections DN 25 to DN 50, DIN 11864-1 and DIN 11864-3

The device is suitable for CIP (Cleaning in Place) when installed accordingly.

Observe temperature and material resistance.

Observe EHEDG-compliant integration into the respective systems:

Prefer installation without cavity.

Ensure self-draining installation of the connection spigots.

Use only EHEDG approved process connections according to the current EHEDG position paper.

When used on tanks, the installation must be flush with the front. Cleaning by direct illumination must be ensured. It must be possible to detect cavity.

Install leakage opening in a clearly visible position. In the case of vertical lines, install pointing downwards.

5 Installation

The following drawing shows an installation example.
Observe dimensions to avoid cavity: $L < D$.

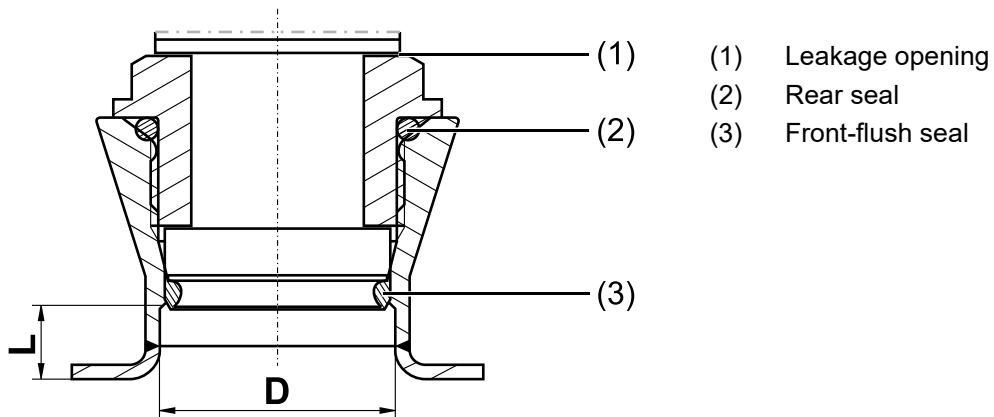

5.3 Installing the device



NOTE!

The pressure measurement membrane is located in the process connection and is very sensitive. Irreparable damage may occur due to sharp or hard objects.

Requirements:

- ✓ The plant has been de-pressurized.
- ✓ The plant pipeline is emptied and flushed.

Procedure:

1. Screw the device into the pipes.
2. If present: Ensure correct position of the seals.
3. Observe tightening torque ⇨ "Process connections ", Page 22.
4. Check for seal tightness.

Result:

The device is now installed in the pipe.

6 Electrical connection

6.1 Terminal assignment

6.1.1 Terminal assignment, M12 connector, SPE

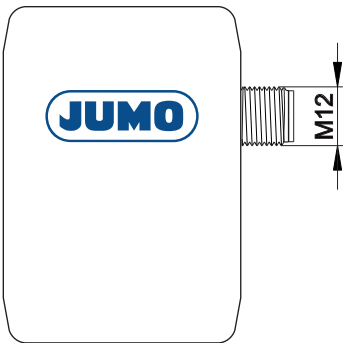
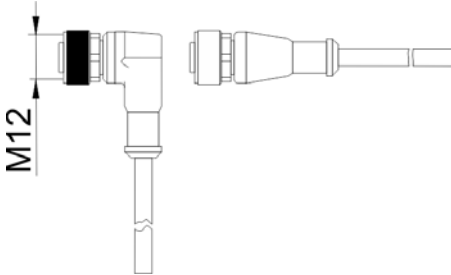
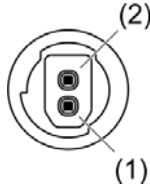
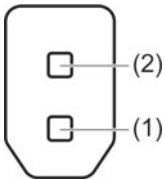
	Device	M12 connecting cable
		
Terminal assignment and color coding RxTx+/PoDL+ RxTx-/PoDL-		
Connection type	Plug connector M12 according to IEC 63171-5	Plug connector M12 with screw locking

6 Electrical connection

6.2 Connecting the device

Aids:

✂ M12 connecting cable for SPE

Requirements:

- ✓ The connections for the voltage supply and signal processing have been prepared.
- ✓ A heat-resistant cable is used (≥ 80 °C).
- ✓ Do not lay the cable near power cables, high-voltage cables or high-frequency cables or maintain a minimum gap of 30 cm from them.

Procedure:

1. Insert the connecting cable into the M12 connector.
2. Tighten the knurled screw by hand on the connecting cable (corresponds to a maximum tightening torque of approx. 0.4 Nm).
3. The device or the process connection must be grounded in the case of ungrounded pipes (e.g. plastic pipes).
Grounding is provided via a separate grounding cable or via a hose clamp, for example.
4. Connect the connecting cable to the device that is processing the signals and to the voltage supply.
5. Lay the connecting cable so that it is protected from mechanical load.

Result:

The device is ready for use.

7.1 Zero point adjustment

An automatic pressure zero point adjustment can be performed. A zero offset depending on position can therefore be corrected, for example.

The current measured value is adopted as a negative offset if the zero point adjustment is performed.

Procedure:

The zero point adjustment can be performed via Modbus TCP or the app.

Modbus TCP:

1. De-pressurize device when installed.
2. If the device displays a measured value which is significantly different from 0, perform zero point calibration. To do so, write the Modbus register 0x0E42 with the ActionValue 0xCEF6D261 ⇒ "Actions", Page 47.

A correction value is now saved in the "Offset" parameter. The device shows a measured value of close to 0.

8 Operation

8.1 Device info display

As soon as the device is supplied with voltage, a device info display appears on the display. The device info display includes information on the software version.

The display is shown depending on the configured display orientation.

After 3 seconds, the device info display switches to the basic status.

8.2 Basic status

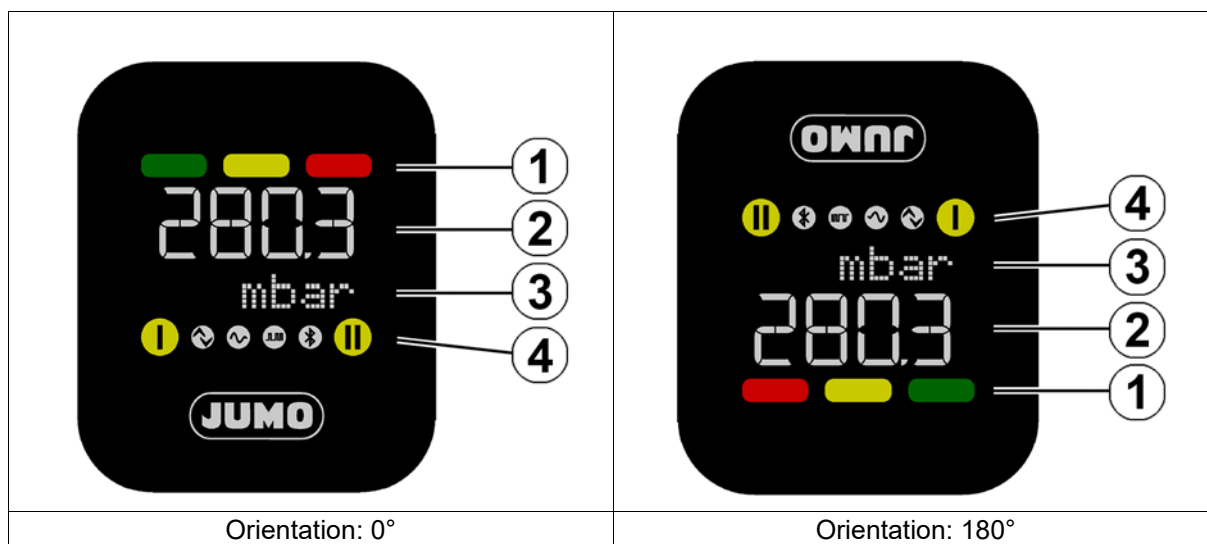

- 1 Device status display
- 2 Process value display
- 3 Text line
- 4 Toolbar

8.2.1 Device status display

Symbol	Designation
	Green continuously lit: Failure-free standard operation Green flashing: "Maintenance required" error category
	Yellow continuously lit: "Outside the specification" error category
	Red continuously lit: "Failure" error category Red flashing: "Functional check" error category

8.2.2 Process value display

4 digits plus prefix sign can be displayed.

The larger the process value, the fewer decimal places are displayed.

If the value falls below -9999 or exceeds +9999, "-----" is displayed instead of the measured value.

In the event of a malfunction, a replacement value is displayed instead of the process value (⇒ "Process value error", Page 49).

8.2.3 Text line

Unit

If there is an error, the unit configured for the display is shown in the text line.

Error message

Error messages and warnings are specified as running text in the text line.

8.2.4 Toolbar



1 Bluetooth connection status

Bluetooth connection status

Symbol	Description
–	Icon off: The Bluetooth wireless module is in the "inactive" or "restricted" operating mode. The device cannot be found during a scan for new devices.
	Flashing icon: Connection can be established Icon continuously lit: Connection active

8.3 Error messages

Error messages and warnings are specified as running text in the text line – alternately with the unit configured for the display. The illuminated fields for the device status display indicate the error category.

For further information ⇒ "Error messages ", Page 49

9 Interfaces

9.1 Bluetooth

The device can be operated and configured via the JUMO smartCONNECT app. The connection is established via Bluetooth. Authentication takes place via NFC.

9.1.1 App download

The "JUMO smartCONNECT" app is available as a free download for Android smartphones (via Google Play) and Apple smartphones (via App Store).

Android smartphones

The app is automatically displayed in the Play Store when the Android smartphone is placed on the device's display so that the NFC antennas are on top of each other.

Alternatively, the QR code below leads directly to the Google Play Store.

Apple smartphones

The app must be installed manually for Apple smartphones. The QR code below leads directly to the Apple App Store.

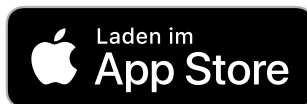

9.1.2 Authentication

In order to operate the device via Bluetooth, authentication is required beforehand. Authentication takes place via an NFC tag that is installed under the device's display.

The following requirements must be met for authentication to take place:

- ✓ The device is switched on.
- ✓ The Bluetooth wireless module is in the "Active" or "Restricted" operating mode.
- ✓ NFC is activated on the smartphone.
- ✓ The app is installed.
- ✓ No other smartphone is connected to the device.

Android smartphones

The smartphone must be placed on the device's display so that the NFC antennas are on top of each other. Authentication then takes place automatically.

Apple smartphones

Click "Add new device" in the open app. The smartphone must then be placed on the device's display so that the NFC antennas are on top of each other.



NOTE!

If authentication is not successful, the NFC antennas of the smartphone and device may be too far apart. The position of the smartphone must be corrected.

The smartphone settings show where the NFC antenna is located.

9.1.3 Connection

If the smartphone has been successfully authenticated, there is a Bluetooth connection between the device and the smartphone.

The device stores the authentication key. If the smartphone is within Bluetooth range, a new connection can be established without NFC – as long as no other smartphone is connected.

The device stores a maximum of 8 authentication keys. If another smartphone is authenticated, the smartphone that has not been connected to the device for the longest time will be deleted from the memory.

If this smartphone is to be connected to the device again, authentication via NFC tag is required again.

9.1.4 Bluetooth settings

Active

By default, Bluetooth is configured as permanently "active".

Restricted

Alternatively, Bluetooth can be configured as "restricted".

In that case, Bluetooth is activated as soon as a smartphone with the NFC antenna switched on is placed on the device's display. If no smartphone connects to the device within 10 seconds, Bluetooth is switched off again.

If the existing Bluetooth connection is lost, a new connection can be established within one minute. After the time has elapsed, Bluetooth turns off again.

Inactive

The Bluetooth connection can also be configured as permanently "inactive". This setting is not available in the app.

Bluetooth can be deactivated via Modbus TCP.

9.1.5 JUMO smartCONNECT app

Start screen

- The current connection status is displayed.
- Under "Demo", the app can be tested even if no suitable device is available.
- Under "Known devices", all devices are displayed for which authentication via NFC tag was successfully performed.
- The x symbol can be used to delete the authentication key on the smartphone.

Establish a connection

The connection between the smartphone and device is established by clicking on the corresponding device name under "Known devices" or "Nearby".

Once the connection to a device is established, the device name must be clicked again. Then the display opens in the app.

Display

After successful connection, information about the device is displayed, such as the name or serial number.

Some process values are also shown.

At the bottom of the screen you will find the following icons:

9 Interfaces



Configuration menu



Device is removed from the "Known devices" list and the authentication key on the smartphone is deleted



Connection between smartphone and device is terminated

9.2 JUMO Cloud

The device can be connected to the JUMO Cloud or any instance of the audako Cloud. Values can be read out and the device configured via the cloud. However, not all parameters are available.

The prerequisite for connecting to the cloud is configuring the device appropriately. This can be performed on the app or via Modbus TCP.

The gateway required to connect to the cloud is integrated into the device. The device is connected to the network via an SPE switch and the data packets are forwarded accordingly.

The MQTT protocol is used.

9.2.1 Data exchange

Data is transferred from the device to the cloud through the cloud gateway.

The data is buffered before transmission. This allows network failures to be bridged without immediately losing data.

The device sends its data to the cloud ("Historical data") via the buffer at the configured interval.

If the live mode is activated, the data is also sent directly – without buffering – to the device ("live data"). The interval for live mode can be configured.



NOTE!

All process values are always transmitted to the cloud in JUMO base units. This happens regardless of what is configured as the unit for the display or for Modbus TCP.

The relevant JUMO base units are:

bar Pressure

9.2.2 Startup

In order for the cloud gateway to work, the following things must be set up in the cloud and then transferred to the device.

1. The device must be assigned to a tenant.
2. A data source must be created. This automatically generates the access data – consisting of device ID and password.
3. A data connection must be set up.
4. A signal must be created in the cloud for each value to be sent from the device to the cloud.

The following information is relevant:

- a) Signal type (analog or binary)
- b) Average value / last value
- c) Interval
- d) Address

The Smart Device Wizard in the cloud simplifies startup.

9.2.3 Further information

A detailed description of the JUMO Cloud can be found in the [help center](#).

9.3 Modbus TCP

The device can be accessed via Modbus TCP using a tool or directly via PLC.



NOTE!

The device only saves the configuration once the relevant action has been performed ⇒ "Actions", Page 47.

Some configuration parameters require the device to be restarted in order to become effective ⇒ "Transfer of configuration", Page 47.



NOTE!

This EEPROM has only a limited number of write cycles. Therefore do not send the save action cyclically.

9.3.1 Transmission

All data types are transmitted in big-endian format according to Modbus standard.

9.3.2 Modbus address tables

⇒ "Modbus address tables", Page 44

10 Configuration

The device has several interfaces and thus several operating options. The configuration parameters are mostly identical. Since the menu structure differs depending on the interface, the configuration parameters are listed sorted by function.

10.1 Display on the device

Parameter	Value	Default setting	Description
Signal selection	None Pressure (physical measurand) Pressure (in % based on the measuring range)	Pressure (physical measurand)	–
Brightness	0 to 10	5	Backlight brightness 0: Display is switched off
Language	German English French Spanish	German	–
Pressure unit	mbar bar hPa kPa MPa psi	bar	Unit of the physical measurand Pressure in percent is created as an independent measuring channel
Display orientation	0 degrees 180 degrees	0 degrees	–

10.2 Interfaces

10.2.1 Bluetooth

Parameter	Value	Default setting	Description
Bluetooth mode	Inactive Restricted Active	Active	Inactive: Bluetooth permanently switched off Restricted: Bluetooth is temporarily activated by NFC tag Active: Bluetooth permanently switched on

10.2.2 Single Pair Ethernet

Network settings

Parameter	Value	Default setting	Description
Method	Manual Automatic (DHCP)	Automatic (DHCP)	Manual: IP address is permanently set in the device Automatic (DHCP): IP address is assigned automatically by DHCP server
IP address	–	0.0.0.0	Only if "Method" = "Manual"
Subnet mask	–	255.255.0.0	Only if "Method" = "Manual"
Standard gateway	–	0.0.0.0	Only if "Method" = "Manual"
DNS server IP automatic	Yes No	Yes	Only if "Method" = "Automatic (DHCP)"
DNS server	–	0.0.0.0	Only if "Method" = "Manual" and "DNS server IP automatic" = "No"

Connection to the JUMO cloud

Parameter	Value	Default setting	Description
Connection to the cloud	Active Inactive	Inactive	–
Cloud server	JUMO Cloud Individual	JUMO Cloud	JUMO Cloud: The JUMO Cloud is used. Individual: The cloud server is determined by an individual URL.
Server URL (device)	–	–	Only if "Cloud Server" = "individual"
Server URL (config)	–	–	Only if "Cloud Server" = "individual"
Device ID	–	–	Access data to the cloud (generated by the cloud)
Password	–	–	Access data to the cloud (generated by the cloud)
Permanent live mode	Active Inactive	Active	If live mode is activated, live data is also transmitted to the cloud in addition to the historical values (for interval, see "Cycle time for live data").
Cycle time for live data	1000 ms to 25000 ms	1000 ms	Time for how often the live data is sent from the device to the cloud. Only if "Permanent Live Mode" = "active"

Modbus TCP

Parameter	Value	Default setting	Description
Port	1 to 1024	502	TCP port of the device
Pressure unit	mbar bar hPa kPa MPa psi	bar	The unit of the Modbus transmission can be configured independently of the display unit. Pressure in percent is created as a separate Modbus register.
Interface activated	Active Inactive	Active	Cannot be set via Modbus TCP.

10 Configuration

10.3 Pressure measurand

Parameter	Value	Default setting	Description
Offset	-999 bar to +999 bar	0 bar	Offset correction to eliminate detected deviation. Measuring range monitoring occurs before the offset is added to the measured value.
Filter time constant	0 s to 99.99 s	0 s	The process value can be attenuated by a 2nd order filter. The larger the filter time constant, the slower the change in measured value at the output.
Simulation default value	-1.1 bar to +110 bar	0 bar	As an aid to device startup, the process value can be simulated.
Simulation activation	Inactive Statistical value	Inactive	Simulation is always switched off after a restart.

10.4 Functions

10.4.1 Limit value monitoring function

Parameter	Value	Default setting	Description
Switching function	Deactivated SinglePointMode Windows Mode TwoPointMode	Deactivated	Deactivated: Limit value switch inactive SinglePointMode: Hysteresis mode ("Switching point SP1" and "Hysteresis") Windows Mode: Window mode ("Switching point SP1", "Release point SP2" and "Hysteresis") TwoPointMode: Two-point mode ("Switching point SP1" and "Release point SP2")
Inversion	HighActive LowActive	HighActive	The limit value logic can be inverted. HighActive: An active limit value switch corresponds to the High signal (logic level 1). LowActive: An active limit value switch corresponds to the Low signal (logic level 0).
Switching point SP1	-1 bar to +100 bar	0 bar	–
Switching point SP2	-1 bar to +100 bar	0 bar	Only for "Switching function" = "WindowMode" and "Two-PointMode"
Hysteresis	0 bar to 100 bar	0 bar	Only for "Switching function" = "SinglePointMode" and "WindowMode"
Switch-on delay	0 s to 100 s	0 s	State is not given to the limit value switch output until after the time has elapsed.
Switch-off delay	0 s to 100 s	0 s	State is not given to the limit value switch output until after the time has elapsed.
Response at error	Low High Frozen	Low	Behavior of the limit value switch output signal when there is a process value error. Low: Low signal (logic level 0) High: High signal (logic level 1) Frozen: Last valid value

Two limit value switches are available for each measurand. All limit value switches can be configured independently of each other.

Different switching modes are selectable, all of which can be inverted. In addition, the limit value switches have a switching delay.

Switching delay

A switching delay for switching on and / or switching off can be configured.

If the switching condition is fulfilled, the set timer for the switch-on delay (Δ_{SP1}) starts to elapse. The state is only output after the time has elapsed. If the switching condition is no longer fulfilled before the time has elapsed, the timer is restarted.

The switch-off delay (Δ_{SP2}) works analogously.

The delay times prevent the output from being switched by measured value peaks or by measured value dips.

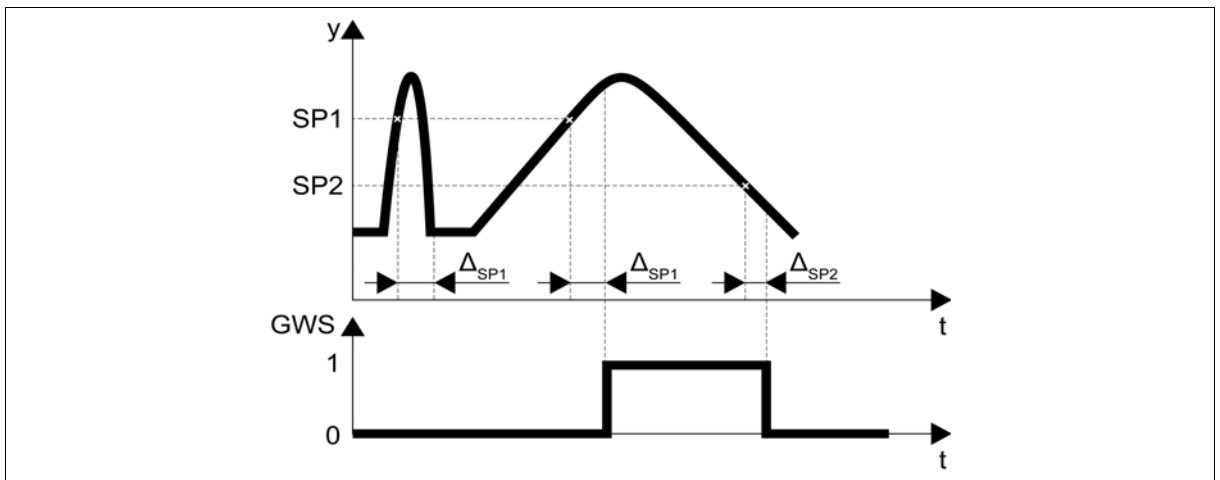

(Δ_{SP1}) Switch-on delay

(Δ_{SP2}) Switch-off delay

(LVS) Limit value switch output signal

(SP1) Switching point

(SP2) Release point

(t) Time

(y) Measured value

(SP_L) Low switching point

Two-point mode

In two-point mode, two switching points are defined. If the process value exceeds the SP_{act} switching point, the limit value switch output becomes active. If the process value falls below the SP_{inact} switching point, the output becomes inactive.

SP_{act} is defined as the larger value of switching points SP1 and SP2, SP_{inact} is correspondingly the smaller of the two values.

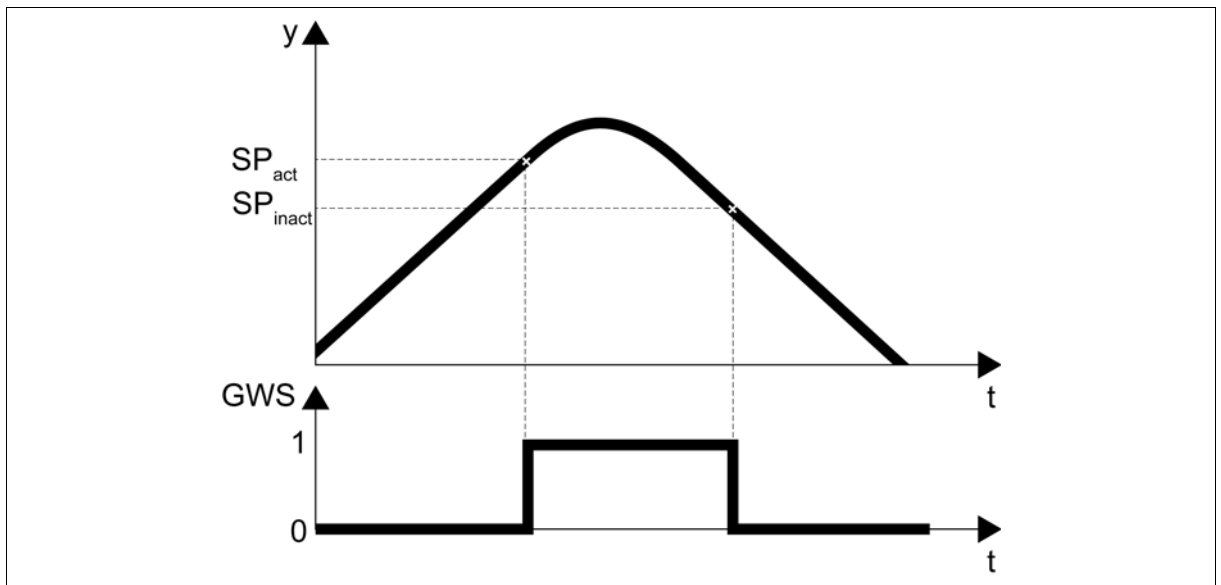

(LVS)	Limit value switch output signal	(t)	Time
(SP _{act})	Active switching point	(y)	Measured value
(SP _{inact})	Inactive switching point		

11 Modbus address tables

11.1 Transmission

All data types are transmitted in big-endian format according to Modbus standard.

11.2 Version and fabrication number

Modbus PDU address		Data type	Number of Modbus registers	Access ^a	Data	Encoding
Dec	Hex					
21	0x0015	string	19	r/-	Software version number	–
70	0x0046	string	11	r/-	Hardware version number	–
110	0x006E	string	10	r/-	Fabrication number	–

^a r/-: Read access

11.3 Configuration

Display

The following settings of the units concern the display on the device. For the Modbus interface the units can be set separately ⇒ "Modbus TCP ", Page 45.

Modbus PDU address		Data type	Number of Modbus registers	Access ^a	Data	Encoding
Dec	Hex					
1000	0x03E8	selection	1	r/w	Language	0: German 1: English 2: French 3: Spanish
1001	0x03E9	selection	1	r/w	Pressure unit	0: mbar 1: psi 2: bar 3: hPa 4: kPa 5: MPa
1002	0x03EA	string	10	r/w	Device name	–
1012	0x03EB	string	18	r/w	DNS name	Name to access the device in the Ethernet network – instead of the IP address
1100	0x044C	selector	6	r/w	Process value	⇒ "Analog selector ", Page 48
1106	0x0452	selection	1	r/w	Display orientation	0: 0° 1: 180°
1107	0x0453	integer	2	r/w	Display brightness	0 to 10

^a r/w: Read and write access

11 Modbus address tables

Analog input

Modbus PDU address		Data type	Number of Modbus registers	Access ^a	Data	Encoding
Dec	Hex					
1200	0x04B0	float	2	r/w	Offset	-999 to +999
1202	0x04B2	float	2	r/w	Filter time constant	0 s to 100 s

^a r/w: Read and write access

Modbus TCP

The following settings of the units concern the Modbus interface. For the display on the device, the units can be set separately ⇒ "Display ", Page 44.

Modbus PDU address		Data type	Number of Modbus registers	Access ^a	Data	Encoding
Dec	Hex					
1600	0x0640	integer	2	r/w	Port gateway	1 to 1024
1602	0x0642	selection	1	r/w	Pressure unit	0: mbar 1: psi 2: bar 3: hPa 4: kPa 5: MPa

^a r/w: Read and write access

Network settings

Modbus PDU address		Data type	Number of Modbus registers	Access ^a	Data	Encoding
Dec	Hex					
1700	0x06A5	selection	1	r/w	Method	0: Manual 1: Automatic
1701	0x06A6	string	8	r/w	IP address	–
1709	0x06AD	string	8	r/w	Subnet mask	–
1717	0x06B5	string	8	r/w	Standard gateway	–
1725	0x06BD	boolean	1	r/w	Assign DNS server IP automatically	–
1726	0x06BE	string	8	r/w	DNS server	–

^a r/w: Read and write access

Bluetooth

Modbus PDU address		Data type	Number of Modbus registers	Access ^a	Data	Encoding
Dec	Hex					
2100	0x0834	selection	1	r/w	Bluetooth mode	0: Inactive 1: Restricted 2: Active

^a r/w: Read and write access

11 Modbus address tables

Limit value function

Modbus PDU address		Data type	Number of Modbus registers	Access ^a	Data	Encoding
Dec	Hex					
2350	0x092E	float	2	r/w	LVS 1: Switching point SP1	-1 bar to +100 bar
2352	0x0930	float	2	r/w	LVS 1: Switching point SP2	-1 bar to +100 bar
2354	0x0932	selection	1	r/w	LVS 1: Inversion	0: HighActive 1: LowActive
2355	0x0933	selection	1	r/w	LVS 1: Switching function	0: Deactivated 1: Hysteresis mode 2: Window mode 3: Two-point mode
2356	0x0934	float	2	r/w	LVS 1: Hysteresis	0 bar to 100 bar
2358	0x0936	selection	1	r/w	LVS 1: Error behavior	0: Inactive 1: Active 2: Frozen
2359	0x0937	float	2	r/w	LVS 1: Switch-on delay	0 s to 100 s
2361	0x0939	float	2	r/w	LVS 1: Switch-off delay	0 s to 100 s

^a r/w: Read and write access

Modbus PDU address		Data type	Number of Modbus registers	Access ^a	Data	Encoding
Dec	Hex					
2375	0x0947	float	2	r/w	LVS 2: Switching point SP1	-1 bar to +100 bar
2377	0x0949	float	2	r/w	LVS 2: Switching point SP2	-1 bar to +100 bar
2379	0x094B	selection	1	r/w	LVS 2: Inversion	0: HighActive 1: LowActive
2380	0x094C	selection	1	r/w	LVS 2: Switching function	0: Deactivated 1: Hysteresis mode 2: Window mode 3: Two-point mode
2381	0x094D	float	2	r/w	LVS 2: Hysteresis	0 bar to 100 bar
2383	0x094F	selection	1	r/w	LVS 2: Error behavior	0: Inactive 1: Active 2: Frozen
2384	0x0950	float	2	r/w	LVS 2: Switch-on delay	0 s to 100 s
2386	0x0952	float	2	r/w	LVS 2: Switch-off delay	0 s to 100 s

^a r/w: Read and write access

11 Modbus address tables

11.4 Actions

Modbus PDU address		Data type	Number of Modbus registers	Access ^a	Data	Encoding
Dec	Hex					
3000	0x0BB8	action	2	r/w	Save configuration	Save (0xC7E7BC2E) Discard (0xF0864181) Default setting (0x34BFE138)
3627	0x0E2B	action	2	r/w	Teach function	Teach SP1 (0x57FBE8) Teach SP2 (0x35800A1)
3650	0x0E42	action	2	r/w	Zero point adjustment	Set zero point (0xCEF6D261)

^a r/w: Read and write access

The status of a triggered action can be checked. For this purpose, the Modbus register of the corresponding action can be read back.

Read-back value	Meaning
0x00000000	The action was performed successfully.
0xFFFFFFFF	An error has occurred when performing the action.
<i>The previously written value</i>	The action has not been performed.

11.5 Process values

Measured values

Modbus PDU address		Data type	Number of Modbus registers	Access ^a	Data	Encoding
Dec	Hex					
6000	0x1770	float	2	r/-	Pressure	–
6002	0x1772	float	2	r/-	Pressure in percent	–

^a r/-: Read access

Transfer of configuration

Modbus PDU address		Data type	Number of Modbus registers	Access ^a	Data	Encoding
Dec	Hex					
6450	0x1932	boolean	1	r/-	Device restart required due to a configuration change	–

^a r/-: Read access

11 Modbus address tables

Limit value monitoring function

Modbus PDU address		Data type	Number of Modbus registers	Access ^a	Data	Encoding
Dec	Hex					
3625	0x0E29	unsigned short integer	1	r/w	Measuring channel for which teach process is to be executed	1: Measuring channel 1 (limit value switch 1) 2: Measuring channel 1 (limit value switch 2)
3626	0x0E2A	unsigned short integer	1	r/-	Result of the teach process	0: Inactive 1: SP1 successful 2: SP2 successful 7: Error
6900	0x1AF4	boolean	1	r/-	Limit value switch 1 output	–
6901	0x1AF5	boolean	1	r/-	Limit value switch 2 output	–

^a r/-: Read access; r/w: Read and write access

11.6 Error

Modbus PDU address		Data type	Number of Modbus registers	Access ^a	Data	Encoding
Dec	Hex					
6400	0x1900	boolean	1	r/-	General error	–
6401	0x1901	boolean	1	r/-	Pressure faulty	–
6402	0x1902	boolean	1	r/-	Configuration faulty	–
6403	0x1903	boolean	1	r/-	Calibration faulty	–
6404	0x1904	boolean	1	r/-	Device not calibrated	–
6405	0x1905	boolean	1	r/-	Simulation active	–
6407	0x1907	boolean	1	r/-	Device operating conditions	–

^a r/-: Read access

11.7 Analog selector

The three-part hash values must be transmitted together in a Modbus message.

Selector	Hash value	
	Hex	Dec
<i>No signal</i>	0x0 – 0x0 – 0x0	0 – 0 – 0
Pressure input	0x4E27A4CC – 0xFFC2981 – 0x8C1C81C3	1311220940 – 268183937 – 2350678467
Pressure input in percent	0xE595E143 – 0xF2461B10 – 0x745595D5	3851804995 – 4064680720 – 1951765973

12.1 Process value error

Process value errors are displayed instead of the process value. In part, process value errors are supplemented with error messages in the text line.

Error message	Cause	Remedy
----	The input value is invalid. The sensor is defective or communication to the sensor is impaired.	Contact the manufacturer.
	There is an internal device error.	Contact the manufacturer.
<<<<	The measuring range was undershot.	Operate the device within the device specifications. If necessary, contact the manufacturer.
>>>>	The measuring range was exceeded.	Operate the device within the device specifications. If necessary, contact the manufacturer.

12.2 Error messages

Error messages and warnings are specified as running text in the text line – alternately with the unit configured for the display. The only error shown is always the one with the highest priority.

The illuminated fields for the device status display indicate the error category based on the NAMUR recommendation NE 107.



red continuously lit

Failure (F)

Error message	Cause	Remedy
Configuration faulty	The checksum of the configuration data is faulty.	Transfer the configuration data to the device again.
Calibration data faulty	The checksum of the calibration data is faulty.	Contact the manufacturer.
Device not calibrated	There is no calibration data.	Contact the manufacturer.
Pressure faulty	The measuring range has been fallen below or exceeded or the pressure sensor has failed.	Operate the device within the device specifications. If necessary, contact the manufacturer.



red flashing

Functional check (C)

Error message	Cause	Remedy
Simulation active	Simulation mode is active.	Deactivate simulation mode or restart the device.

12 Troubleshooting



green flashing

Maintenance required

Error message	Cause	Remedy
Restart the device	The device must be restarted due to a configuration change.	Restart the device.



yellow continuously lit

Outside the specification (S)

Error message	Cause	Remedy
Device operating conditions	The device is operated outside the device specifications.	Operate the device within the device specifications.

13.1 Maintenance

The device is maintenance-free.

13.2 Cleaning

13.2.1 Cleaning device housing

Clean the device from the outside with a cloth moistened with water or with a mild cleaning agent. Do not use any aggressive or flammable cleaning agents.

13.2.2 Clean measurement membrane



NOTE!

The pressure measurement membrane is located in the process connection and is very sensitive. Irreparable damage may occur due to sharp or hard objects.

Requirements:

- ✓ The device is disassembled.
- ✓ A cleaning station for rinsing all parts in contact with the medium is prepared.

Procedure:

1. If present: Remove seals on the process connection.
2. Carefully flush pressure measurement membrane with water. If necessary, use a mild cleaning agent.
3. Check the seals for damage and replace if necessary.

Result:

The pressure measurement membrane has been cleaned. The device can now be installed, disposed of, or returned.

14 Shutdown

14.1 Dismounting



WARNING!

Risk of injury resulting from pressurized systems!

Opening the pressurized system could result in people becoming injured by components that are slung away or by the escaping medium.

- ▶ Before starting with the mounting, make sure that the system is depressurized.
-

Requirements:

- ✓ The plant has been de-pressurized.
- ✓ The plant pipeline is emptied and flushed.
- ✓ The device has cooled down.

Procedure:

1. Loosen the knurled screw on the connecting cable by hand.
2. Pull the connecting cable out of the M12 connector.
3. Unscrew the device.
4. Carefully remove the device from the plant and put in a clean and dry place.

Result:

The device is disassembled and can be used elsewhere.

14.2 Returns

Requirements:

- ✓ The device housing is cleaned.
- ✓ The pressure measurement membrane has been cleaned.

Procedure:

1. The [supplementary sheet for product returns](#) must first be completed correctly and signed. Then enclose it with the shipping documents and attach it to the packaging, ideally on the outside.
2. Use the original packaging or a suitably secure container for sending the device.

14.3 Disposal

Requirements:

- ✓ The device housing is cleaned.
- ✓ The pressure measurement membrane has been cleaned.



- Do not dispose of the device or replaced parts in the trash after use.
- Delete programs and data stored on the device.
- Remove batteries, if any, if this can be done without damaging the device.
- Dispose of the device and the packaging material in a responsible and environmentally friendly manner.
- Observe the country-specific laws and regulations for waste treatment and disposal.

In accordance with Directive 2012/19/EU on Waste from Electrical and Electronic Equipment, manufacturers are obliged to offer the option of returning waste equipment. Request the return from the manufacturer.

15 Accessories

Without UL approval

Designation	Part no.
SPE network cable 1 m (with M12 connector)	30062458
SPE network cable 2 m (with M12 connector)	30062457
SPE network cable 5 m (with M12 connector)	30062456
SPE network cable 10 m (with M12 connector)	30062455
SPE connector according to IEC 63171-2 (IP20)	30062461
T-piece with PEKA connection DN 25, EHEDG	00643555
T-piece with PEKA connection DN 32, EHEDG	00643574
T-piece with PEKA connection DN 40, EHEDG	00643576
T-piece with PEKA connection DN 50, EHEDG	00643579
T-piece with PEKA connection DN 65, EHEDG	00643580
T-piece with PEKA connection DN 80, EHEDG	00643581
T-piece with PEKA connection DN 100, EHEDG	00643582
Service deployment	00427970
Preconfiguration (Service)	00427968
JUMO smartCONNECT (App)	00770436

With UL approval

Designation	Part no.
SPE network switch 4-port (10BASE-T1L)	30062113
SPE network switch 8-port (10BASE-T1L)	30062447

16 Open-source software

The device software and/or device components were developed using open-source software.

Insofar as the respectively applicable license terms justify a claim on the provision of source code or other information, JUMO GmbH & Co. KG will provide the source code and the license texts on a conventional data carrier at the cost incurred for the provision of the data carrier.

This offer is valid for three years after the software is made available. This offer is valid beyond that time to the extent specified in the license terms.

For questions related to open-source software, please contact:

Address JUMO GmbH & Co. KG
License Compliance
Moritz-Juchheim-Straße 1
36039 Fulda, Germany

Email licensecompliance@jumo.net



JUMO GmbH & Co. KG

Street address:
Moritz-Juchheim-Straße 1
36039 Fulda, Germany

Delivery address:
Mackenrodtstraße 14
36039 Fulda, Germany

Postal address:
36035 Fulda, Germany

Phone: +49 661 6003-0
Fax: +49 661 6003-607
Email: mail@jumo.net
Internet: www.jumo.net

JUMO UK LTD

JUMO House
Temple Bank, Riverway
Harlow, Essex, CM20 2DY, UK

Phone: +44 1279 63 55 33
Fax: +44 1279 62 50 29
Email: sales@jumo.co.uk
Internet: www.jumo.co.uk

JUMO Process Control, Inc.

6724 Joy Road
East Syracuse, NY 13057, USA

Phone: +1 315 437 5866
Fax: +1 315 437 5860
Email: info.us@jumo.net
Internet: www.jumousa.com

