

6. Unit
☐ H : bar ☐ I : MPa ☐ J : kPa ☐ S : mbar
7. Range
 XXX : Refer to pressure unit and range table
8. Over range protection
☐ 0 : Overpressure safety 130 % of full scale value
☐ 1 : Overpressure safety 500 % of full scale value, Max. 4 Mpa
9. Option
☐ 0 : None
☐ 1 : Accessories

— Standard specifications—

11. Working pressure
 Steady : Full scale value
 Fluctuating : 90% of full scale value
12. Over range protection
 Overpressure safety 130% of full scale value
 Overpressure safety 500% of full scale value, Max. 4 MPa (Option)
13. Working temperature
 Ambient : -20 ~ 65°C
 Fluid : Max. 100°C
14. Degree of protection
 EN60529/IEC529/IP67
15. Element type : Diaphragm
16. Conduit connection : M20 X 1.5P
17. Mat'l
 1) Case & Cover : Stainless steel (304SS)
 2) Upper flange
☐ 304SS ☐ 316SS
 3) Diaphragm
☐ ≤40 kPa stainless steel(316Ti SS)
☐ >40 kPa duratherm 600
 4) Pressure connection and under flange
☐ 304SS ☐ 316SS ☐ 316L SS
 5) Movement : Stainless steel
 6) Windows
☐ Safety glass : Only available with diameter 100 mm
☐ Polycarbonate : 100 and 160 mm
18. Dimension

	A	B	D	E	F	H	N	C	
								≤40kPa	>40 kPa
100mm	101.3	99	50	78	16	34.5	75	150	100
160mm	160.6	159	52.5	108	15.8	34	105		

- Main order —
1. Base model
☐ P572 : "I" type flange process connection
2. Nominal diameter and window material
☐ 4 : 100 mm and safety glass
☐ 5 : 100 mm and polycarbonate window
☐ 6 : 160 mm and polycarbonate window
3. Contact function
☐ 1 : High alarm, Normal open contact
☐ 2 : High and low alarm
☐ 3 : Low alarm, Normal close alarm
☐ 4 : Two High alarm
☐ 5 : Two Low alarm
☐ 6 : Failsafe high and low alarm
4. Process connection
 XX : Refer to process connection type table
5. Flange material
☐ B : 304SS ☐ D : 316SS ☐ E : 316L SS

— Sample ordering code—

1	2	3	4	5	6	7	8	9
P572	6	1	XX	D	H	XXX	0	0

2								
1								
NO	REASON			DATE	PREPARED BY	CHECKED BY	APPROVED BY	

REVISION

This drawing and the specifications are the intellectual property of WISE CONTROL INC. therefore, without a prior written consent from WISE CONTROL INC., it is strictly prohibited to reproduce the drawing or manufacture the identical products according to its specifications provided here.

Unless otherwise specified
 Decimal dimensions ±5
 Angle dimensions ±1°
 Dimensions are in milli meter

THIRD ANGLE PROJECTION

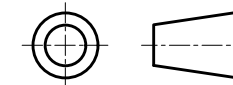

	SIGNATURE	DATE
PREPARED BY	K.S.LEE	18.06.01
REVIEWED BY	J.S.PARK	18.06.01
APPROVED BY	D.M.CHO	18.06.01
REV. NO.	0	

WISE®

WISE Control Inc.

DRAWING TITLE :
 ELECTRICAL CONTACT TYPE
 DIAPHRAGM P/G

DWG NO.
 P572XXXA-S.T.D

SCALE : N/S W.T. SHEET OF