

## 5. Process connection

□ D : 3/8"

## 6. Connection type

□ B : PF

## 7. Unit

□ H : bar

□ I : MPa

□ J : kPa

## 8. Range

□ 029 : -0.1 ~ 0.3 MPa (-1 ~ 3 bar)

□ 031 : -0.1 ~ 0.6 MPa (-1 ~ 6 bar)

□ 032 : -0.1 ~ 1.0 MPa (-1 ~ 10 bar)

## 9. Dial color

□ 6 : 3 colors

## 10. Option

□ 0 : None

□ 1 : Accessories

## - Standard specifications -

## 11. Working pressure

Steady : 75% of full scale value

Over range protection : 130% of full scale

## 12. Working temperature

Ambient : -40 ~ 65°C

Fluid : Max. 100°C

## 13. Degree of protection : EN60529/IEC529/IP67

## 14. Element type : Bourdon tube

## 15. Mat'l

1) Case &amp; Cover : 316SS

2) Element : Stainless steel (316SS)

3) Process connection : Stainless steel (316SS)

4) Movement : Stainless steel

5) Windows : Safety glass

## - Main order -

1. Base model : □ P543 (Electrical contact type pressure gauge, triple contact)

2. Nominal diameter (mm)

□ 6 : 150

3. Type of mounting

□ B : Bottom entry and surface mounting flange

4. Accuracy

□ 3 : ±1.0% of full scale

## - Sample ordering code -

1	2	3	4	5	6	7	8	9	10
P542	6	B	3	D	B	H	029	6	0

2					
1					
NO	REASON	DATE	PREPARED BY	CHECKED BY	APPROVED BY

## REVISION

This drawing and the specifications are the intellectual property of WISE CONTROL INC. therefore, without a prior written consent from WISE CONTROL INC., it is strictly prohibited to reproduce the drawing or manufacture the identical products according to its specifications provided here.

Unless otherwise specified  
 Decimal dimensions ±5  
 Angle dimensions ±1°  
 Dimensions are in milli meter

## THIRD ANGLE PROJECTION

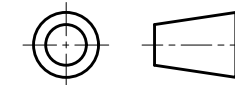

	SIGNATURE	DATE
PREPARED BY	K.S.LEE	18.06.01
REVIEWED BY	J.S.PARK	18.06.01
APPROVED BY	D.M.CHO	18.06.01
REV. NO.	0	

**WISE**<sup>®</sup>

WISE Control Inc.

 DRAWING TITLE :  
 PRESSURE  
 INDICATING SWITCH

 DWG NO.  
 P543150B-S.T.D

SCALE : N/S    W.T.    SHEET OF