

5. Process connection

☐ D : 3/8"

6. Connection type

☐ B : PF

7. Unit

☐ H : bar ☐ I : MPa ☐ J : kPa

8. Range

☐ 029 : -0.1 ~ 0.3 MPa (-1 ~ 3 bar)☐ 031 : -0.1 ~ 0.6 MPa (-1 ~ 6 bar)☐ 032 : -0.1 ~ 1.0 MPa (-1 ~ 10 bar)

9. Dial color

☐ 6 : 3 colors

10. Option

☐ 0 : None☐ 1 : Accessories

- Standard specifications -

11. Working pressure

Steady : 75% of full scale value

Over range protection : 130% of full scale

12. Working temperature

Ambient : -40 ~ 65°C

Fluid : Max. 100°C

13. Degree of protection : EN60529/IEC529/IP67

14. Element type : Bourdon tube

15. Mat'l

1) Case & Cover : Nickel plated zinc

2) Element : Stainless steel (316SS)

3) Process connection : Stainless steel (316SS)

4) Movement : Stainless steel

5) Windows : Safety glass

- Main order -

1. Base model : ☐ P542 (Electrical contact type pressure gauge, dual contact)

2. Nominal diameter (mm)

☐ 4 : 100

3. Type of mounting

☐ B : Bottom entry and surface mounting flange

4. Accuracy

☐ 3 : \pm 1.0% of full scale

This drawing and the specifications are the intellectual property of WISE CONTROL INC. therefore, without a prior written consent from WISE CONTROL INC., it is strictly prohibited to reproduce the drawing or manufacture the identical products according to its specifications provided here.

Unless otherwise specifiedDecimal dimensions \pm 5Angle dimensions \pm 1°

Dimensions are in milli meter

THIRD ANGLE PROJECTION

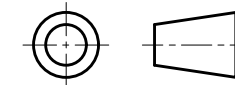
**WISE**[®]

WISE Control Inc.

	SIGNATURE	DATE
PREPARED BY	K.S.LEE	18.06.01
REVIEWED BY	J.S.PARK	18.06.01
APPROVED BY	D.M.CHO	18.06.01
REV. NO.	0	

DRAWING TITLE :
PRESSURE
INDICATING SWITCHDWG NO.
P542100B-S.T.D

SCALE : N/S W.T. SHEET OF

- Sample ordering code -

1	2	3	4	5	6	7	8	9	10
P542	4	B	3	D	B	H	029	6	0

2					
1					
NO	REASON	DATE	PREPARED BY	CHECKED BY	APPROVED BY
REVISION					