

— Main order —

1. Base model : P255 (Crimp-on-ring case pressure gauge)
2. Nominal diameter (mm)
 - ☐ 2 : 63 ☐ 3 : 80 ☐ 4 : 100
3. Type of mounting
 - ☐ G : Lower back connection, direct
4. Accuracy
 - ☐ 3 : $\pm 1.0\%$ of full scale.(Only available with diameter 100 mm)
 - ☐ 4 : $\pm 1.6\%$ of full scale.(Only available with diameter 63 and 80 mm)
5. Process connection
 - ☐ C : 1/4"
 - ☐ D : 3/8", not available with diameter 63 mm
 - ☐ E : 1/2", not available with diameter 63 and 80 mm
 - ☐ P : 7/16"(UNF)

6. Connection type
 - ☐ B : PF ☐ C : PT ☐ D : NPT
 - ☐ E : UNF ☐ F : BSPT ☐ G : BSP(G)
 - ☐ Z : Other -----
7. Unit
 - ☐ H : bar ☐ I : MPa ☐ J : kPa
8. Range

XXX : Refer to pressure unit and range table
9. Pressure connection material and dial color
 - ☐ 3 : 316SS and 2 colors
 - ☐ 7 : 316SS and 3 colors
10. Option
 - ☐ 0 : None
 - ☐ 9 : Glycerin filling

— Standard specifications—

11. Working pressure
 - Steady : 75% of full scale
 - Over range protection : 130% of full scale
12. Working temperature
 - Ambient : $-40 \sim 60^{\circ}\text{C}$
 - $-20 \sim 65^{\circ}\text{C}$ (With glycerin filling)
 - Fluid : Max. 200°C
 - Max. 100°C (With glycerin filling)
13. Degree of protection

EN60529/IEC529/IP67
14. Element type : Bourdon tube
15. Mat'l
 - 1) Case & Cover : Stainless steel (Only 304SS)
 - 2) Element : Stainless steel
 - 3) Process connection : Stainless steel (316SS)
 - 4) Movement : Stainless steel
 - 5) Windows : Safety glass
16. Dimension

	A	B	D	E	F
63mm	67.8	62	34	45	13
80mm	84.8	78.5	36	50	22
100mm	106.8	99	47	62	29

— Sample ordering code—

1	2	3	4	5	6	7	8	9	10
P255	4	G	4	E	D	I	XXX	3	0

2					
1					
NO	REASON	DATE	PREPARED BY	CHECKED BY	APPROVED BY
REVISION					

This drawing and the specifications are the intellectual property of WISE CONTROL INC. therefore, without a prior written consent from WISE CONTROL INC., it is strictly prohibited to reproduce the drawing or manufacture the identical products according to its specifications provided here.

Unless otherwise specified
 Decimal dimensions ± 0.05
 Angle dimensions $\pm 1^{\circ}$
 Dimensions are in milli meter

THIRD ANGLE PROJECTION

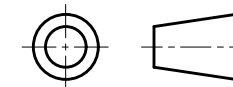

	SIGNATURE	DATE
PREPARED BY	K.S.LEE	18.06.01
REVIEWED BY	J.S.PARK	18.06.01
APPROVED BY	D.M.CHO	18.06.01
REV. NO.	0	

WISE[®]

WISE Control Inc.

DRAWING TITLE :
 "G" Type Crimp-on-ring
 case pressure guage

DWG NO.
 P255XXXG-S.T.D

SCALE : N/S W.T. SHEET OF