

— Main order —

1. Base model : P255 (Crimp-on-ring case pressure gauge)
2. Nominal diameter (mm)
  - ☐ 2 : 63
3. Type of mounting
  - ☐ F : Center back connection, direct
4. Accuracy
  - ☐ 4 :  $\pm 1.6\%$  of full scale.
5. Process connection
  - ☐ C : 1/4"
  - ☐ P : 7/16"(UNF)

6. Connection type

- ☐ B : PF    ☐ C : PT    ☐ D : NPT
- ☐ E : UNF    ☐ F : BSPT    ☐ G : BSP(G)
- ☐ Z : Other \_\_\_\_\_

7. Unit

- ☐ H : bar    ☐ I : MPa    ☐ J : kPa

8. Range

XXX : Refer to pressure unit and range table

9. Pressure connection material and dial color

- ☐ 3 : 316SS and 2 colors
- ☐ 7 : 316SS and 3 colors

10. Option

- ☐ 0 : None
- ☐ 9 : Glycerin filling

— Standard specifications—

11. Working pressure

Steady : 75% of full scale

Over range protection : 130% of full scale

12. Working temperature

Ambient :  $-40 \sim 60^{\circ}\text{C}$

$-20 \sim 65^{\circ}\text{C}$  (With glycerin filling)

Fluid : Max.  $200^{\circ}\text{C}$

Max.  $100^{\circ}\text{C}$  (With glycerin filling)

13. Degree of protection

EN60529/IEC529/IP67

14. Element type : Bourdon tube

15. Mat'l

- 1) Case & Cover : Stainless steel (Only 304SS)
- 2) Element : Stainless steel
- 3) Process connection : Stainless steel (316SS)
- 4) Movement : Stainless steel
- 5) Windows : Safety glass

— Sample ordering code—

1	2	3	4	5	6	7	8	9	10
P255	2	F	4	C	D	I	XXX	3	0

2					
1					
NO	REASON	DATE	PREPARED BY	CHECKED BY	APPROVED BY
REVISION					

This drawing and the specifications are the intellectual property of WISE CONTROL INC. therefore, without a prior written consent from WISE CONTROL INC., it is strictly prohibited to reproduce the drawing or manufacture the identical products according to its specifications provided here.

Unless otherwise specified  
 Decimal dimensions  $\pm 0.05$   
 Angle dimensions  $\pm 1^{\circ}$   
 Dimensions are in millimeter

THIRD ANGLE PROJECTION

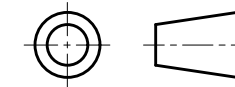

	SIGNATURE	DATE
PREPARED BY	K.S.LEE	18.06.01
REVIEWED BY	J.S.PARK	18.06.01
APPROVED BY	D.M.CHO	18.06.01
REV. NO.	0	

**WISE**<sup>®</sup>

WISE Control Inc.

DRAWING TITLE :  
 "F" Type Crimp-on-ring  
 case pressure gauge

DWG NO.  
 P255XXXF-S.T.D

SCALE : N/S    W.T.    SHEET OF